

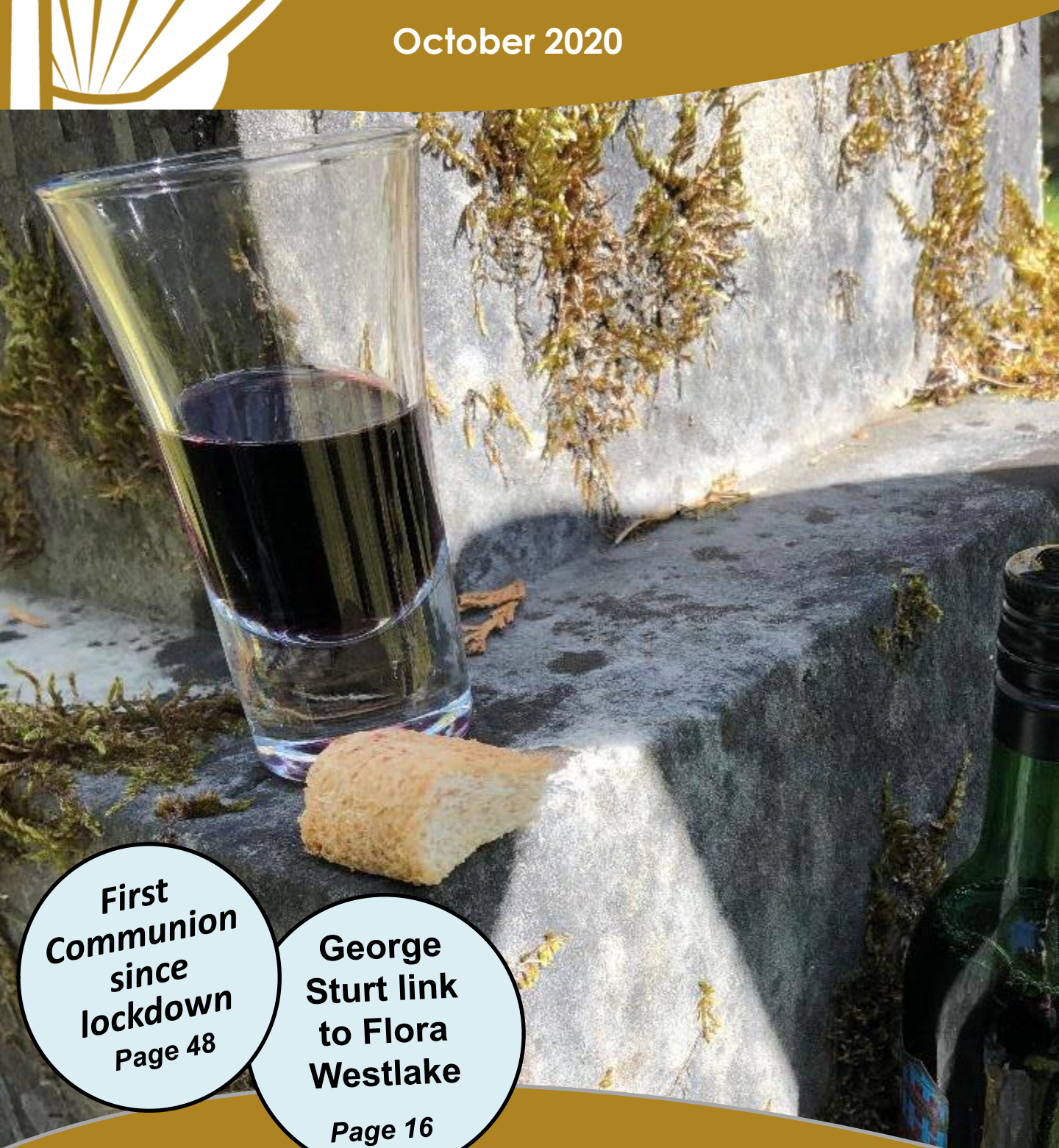

# ROWLEDGE Review

90p

October 2020



**First  
Communion  
since  
lockdown**  
Page 48

**George  
Sturt link  
to Flora  
Westlake**

**Page 16**

Rowledge • Boundstone  
Holt Pound • Bucks Horn Oak



Produced for the community by

**St. James' Church**  
Rowledge

# The Hare & Hounds



*Fresh home-cooked food and a friendly welcome.*

**Lockdown Take-Aways available**

*A touch of Irish charm  
at the heart of the village.*



**The Square, Rowledge, GU10 4AA**

**Tel: 01252 792287**

## MARTIN CASHMORE FENCING LTD

### SUPPLIER & CONTRACTOR

Our family run business was established in 1982. We are located just outside Farnham on the A325. We stock a large quantity of Fencing Materials, Oak and Softwood Sleepers, Gates, Wire Fencing, Tools, Fittings and much more.

We offer a prompt delivery service to a wide area.

We supply and install all types of Fencing and Gates, please contact us for a free quote.

01420 521040

[jake.mcfsales@btinternet.com](mailto:jake.mcfsales@btinternet.com)



[www.martincashmore.co.uk](http://www.martincashmore.co.uk)

Unit 2, Halfway Farm, Dockenfield Road,  
Bucks Horn Oak, Farnham, GU10 4LP







## From the Vicarage

Apparently, lots of us have been talking to ourselves more than ever during lockdown. And that's not necessarily a bad thing.

A New York Times article in June 2017 looked at some of the benefits of talking to ourselves. Apparently, 'external self-talk' can help us look at a situation objectively and without emotion.

It can be motivating and can even help speed up our cognitive abilities in relation to problem-solving or getting a job done. According to Professor Gary Lupyan, 'Talking to yourself out loud can help you keep out distractions and remind yourself where you are.'

With all the disorientation of the last few months, it's not surprising that we might need to 'remind ourselves where we are'. We need to make sure though that what we're saying to ourselves is right.

Paul's letter to the Philippians provides a checklist for this:

*"Finally brothers and sisters, whatever is true, whatever is noble, whatever is right, whatever is pure, whatever is lovely, whatever is admirable – if anything is excellent or praiseworthy – think about such things."*

### Philippians 4:8

Sometimes it's helpful to have specifics, especially on days when life feels particularly difficult. In his excellent book 'Radical Gratitude', Peter Maiden writes of the discipline of intentionally remembering God's goodness and he says, 'the deliberate engagement of the mind in times of difficulty and disappointment is key to living a life of gratitude'. And Mark Meynell, in his profound book, 'When Darkness Seems My Closest Friend', reminds us that the character of God as revealed in Christ should be at the heart of our internal dialogue.

The psalmist helps us too. I was recently reflecting on Psalm 103 which reminds me of the benefits of speaking truth to our souls about God's character:

*"(He) forgives all your sins  
and heals all your diseases,  
who redeems your life from the pit,  
and crowns you with love and compassion,  
who satisfies your desires with good things,  
so that your youth is renewed like the eagle's."*

So if you see me talking to myself, don't worry, but maybe give it a try!

Blessings,

Russ Gant, Vicar

## BIBLE READING NOTES

As a church, St James' offer the opportunity to have daily bible readings with notes in book form, which is published three times a year, or by daily email. The full cost would be £17.95 but, by annual subscription through the church, this is reduced to £14.10.

### Try before you buy!

I have some past copies of New Daylight (Bible Reading Fellowship) and would be pleased to give them to anyone who might be interested. Please call **Sue Kelly** on **01252 795433** or Email on **suekelly@madasafish.com**



## BEATITUDES

FOR A GLOBAL PANDEMIC

BLESSED ARE THOSE WHO STAY INDOORS.



FOR THEY HAVE PROTECTED OTHERS

BLESSED ARE THE UNEMPLOYED AND THE SELF-EMPLOYED



FOR THEIR NEED OF GOD IS GREAT

BLESSED ARE THE CORNER SHOPKEEPERS



FOR THEY ARE THE PURVEYORS OF SCARCE THINGS

BLESSED ARE THE DELIVERY DRIVERS AND THE POSTAL WORKERS



FOR THEY ARE THE BRINGERS OF ESSENTIAL THINGS

BLESSED ARE THE HOSPITAL WORKERS, THE AMBULANCE CREWS, THE DOCTORS, THE NURSES, THE CARE ASSISTANTS, AND THE CLEANERS



FOR THEY STAND BETWEEN US AND THE GRAVE, AND THE KINGDOM OF HEAVEN IS SURELY THEIRS

BLESSED ARE THE CHECKOUT WORKERS

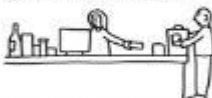

FOR THEY HAVE PATIENCE AND FORTITUDE IN THE FACE OF OVERWORK AND FRUSTRATION

BLESSED ARE THE REFUSE COLLECTORS



FOR THEY WILL SEE GOD DESPITE THE MOUNTAINS OF WASTE

BLESSED ARE THE TEACHERS



FOR THEY REMAIN STEADFAST AND CONSTANT IN DISTURBING TIMES

BLESSED ARE THE CHURCH WORKERS, THE DEACONS, PRIESTS AND BISHOPS



FOR THEY ARE A COMFORTING PRESENCE IN A HURTING WORLD AS THEY CONTINUE TO SIGNPOST TOWARDS GOD

BLESSED ARE THE SINGLE PARENTS.



FOR THEY ARE COPING ALONE WITH THEIR RESPONSIBILITIES AND THERE IS NO RESPIRE

BLESSED ARE THOSE WHO ARE ALONE.



FOR THEY ARE CHILDREN OF GOD AND WITH HIM THEY WILL NEVER BE LONELY

BLESSED ARE THE BEREAVED.



FOR WHOM THE WORST HAS ALREADY HAPPENED THEY SHALL BE COMFORTED

BLESSED ARE THOSE WHO ARE ISOLATED WITH THEIR ABUSERS



FOR ONE DAY - WE PRAY - THEY WILL KNOW SAFETY

BLESSED ARE ALL DURING THIS TIME WHO HAVE PURE HEARTS; ALL WHO STILL HUNGER AND THIRST FOR JUSTICE; ALL WHO WORK FOR PEACE AND WHO MODEL MERCY



MAY YOU KNOW COMFORT. MAY YOU KNOW CALM. AND MAY THE GRACE OF OUR LORD JESUS CHRIST, AND THE LOVE OF GOD, AND THE FELLOWSHIP OF THE HOLY SPIRIT, BE WITH US ALL. AMEN

TEXT: JAYNE MANFREDI

CartoonChurch.com



## IN OUR PRAYERS

If you have any specific prayer requests you are invited to email **prayer@stjamesrowledge.org.uk** (or contact Russ by phone) who will ensure the church prays for your situation.

## Morning Prayers

Morning Prayer is every Wednesday at 9:15am. We will continue to meet virtually for approximately half an hour. Email **vicar@stjamesrowledge.org.uk** to receive a Zoom invitation.



## Church Services

*"The times they are a changin'",* so said Bob Dylan. How reassuring it is to know that the God we follow is unchanging in his steadfast love for us.

There are lots going on at St. James', but with the proviso that events may be subject to change at short notice. We will try to keep you up to date as we get additional information.

### Sunday 20<sup>th</sup> September Service of Holy Communion

If you weren't able to view our Sunday service as it was streamed on Facebook, the recording has now been added to YouTube and you can view it here:

<https://www.youtube.com/watch?v=h-bZvHP3nUA&t=1751s>

If you attended the service, (which was the first back in church) and you have any feedback on how you felt it worked (or didn't) please do let me know. Also, see page 48



## October Sermon series – “In the Wilderness”

### 4<sup>th</sup> October

Philippians 1: 12-20

#### **“Nothing is wasted in the Wilderness”**

Introduction to the sermon series

### 11<sup>th</sup> October

Exodus 3: 1-17

#### **“Encounter in the Wilderness”**

Moses meets the great ‘I AM’

### 18<sup>th</sup> October

Exodus 13: 17-14: 4

#### **“Guidance in the Wilderness”**

The people of Israel led through the wilderness

### 25<sup>th</sup> October

1 Samuel 24: 1-22

#### **“Mercy in the Wilderness”**

David and Saul’s encounter in the cave

**Nothing is wasted**

**Encounter**



**Guidance**

**Mercy**



# ST JAMES' CHURCH – OCTOBER SERVICES

## Sunday services – we still “MEET”!

During the pandemic, regrettably we are unable to meet as a whole congregation in church weekly, physically, for worship – however, we have been continuing to worship together virtually every week. You can view our weekly service on YouTube.

We have met for services outside and trialled services in the church, but maintaining social distancing is proving to be an issue, so we can't fit the whole usual congregation, which the PCC are currently discussing. We will report back as soon as we are able.

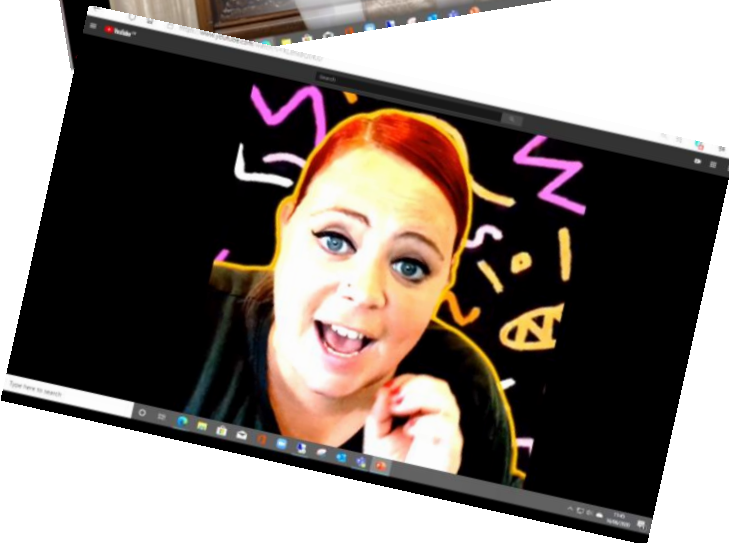
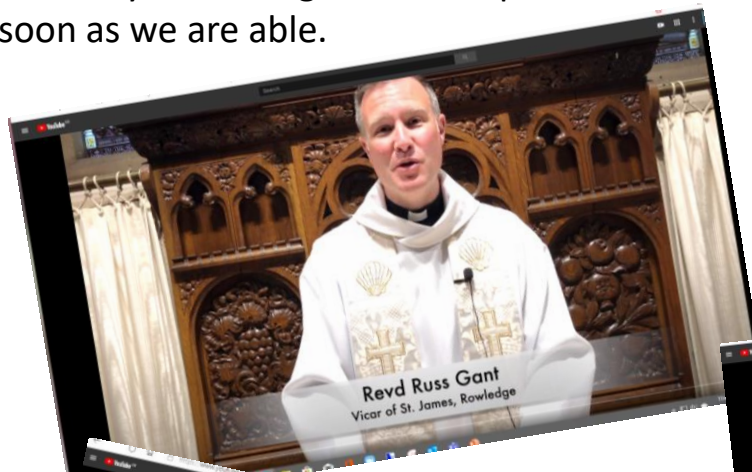

## Sunday Madness

A weekly “gathering” on YouTube, put together by Adele and Beth, suitable for children and young people

## Daily Reflections/Thursday Thought

Russ sent out daily reflections for the first 3 months of lockdown, but is now sending out a weekly Thursday Thought



If you want to receive email invitations to any of our online resources, email [vicar@stjamesrowledge.org.uk](mailto:vicar@stjamesrowledge.org.uk).

## Life Groups –Tuesday & Thursday

Russ & Jenny Gant run a group on Thursday with about 8 people. They meet weekly via Zoom and are continuing their study on Romans.

The Tuesday group currently have 10 people accessing access the group meeting via Zoom. They meet fortnightly for bible study and prayer.

Having completed our series looking at 'Who is the Christ?' ending with 'Christ the Commissioner' they returned to studies of the Parables.

In the weeks between the studies we meet socially on Zoom for a catch up and sometimes prayer if there are specific needs.

## Men's Group – First Thursday of the month

We usually meet every 1<sup>st</sup> and 3<sup>rd</sup> Thursday of the month in the Old Vicarage and the Hare & Hounds for a pensive pint (or two!) and discussion. Starting with a Bible passage discussion then moves on to ...well, anywhere and everywhere!

During lockdown, the Men's Group has met twice by Zoom - first Thursday of every month. We have had 8 - 11 people joining the meetings, which Roy has stage managed, and Brian has led with some very interesting perspectives on the 10 Commandments, Jesus' teaching on them, and some challenges with complying with them in our modern society. Subject to technology, we hope to continue to meet. All welcome. **To join in, contact Rob: [robriscs@aol.com](mailto:robriscs@aol.com)**

## Church is OPEN!

**Open: Monday - Thursday 10am-4pm.  
Saturday - Sunday 8am-8pm.  
Closed on Fridays.**

St James' Church is now OPEN for **individual private prayers**. Individual private prayer is defined as a person or household entering the church to pray on their own, not as part of a group, and not participating in any form of led prayers or communal act. Those praying should be socially distanced from other individuals or households.

It is sacred space within the village, a refuge for quiet and reflection, and everyone is welcome to visit, or come and sit, to think, to pray, to find some space.





## **CROSBY BUILDING SERVICES LTD**

*A local firm built upon excellent reputation*

New Builds : Extensions : Alterations : Design to Completion

Roofing : Landscaping : Carpentry

Plastering : Painting & Decorating

***Bespoke Oak Garages : Garden Buildings : Playhouses***

*We offer a complete service for all your home improvements*

*Free quotations & references available*

**01483 810119**

*Email enquiries @crosbybuilding.co.uk*

*www.crosbybuilding.co.uk*

*Members of the Guild of Master Craftsmen*

# **alpha decor**

**01252 724675**

Complete decorating service

Interior and exterior painting      Wallpaper hanging

In business locally for over 25 years

## **david horne**

# **Clear All Pest Control**



**Fully qualified professional country services**

**Specialising in Hornets, Wasps & Moles**

**Phone Dean on: 07768 986 338 or**

**www.clearallpestcontrol.com**







**Little Fishes**  
Nursery School

## Helping grow happy, confident kids

Discover a fun and friendly nursery school in a  
peaceful location on the edge of Alice Holt Forest

2 years + / Qualified & friendly teachers / All-weather garden  
Fun daily activities inc forest adventures / Early years funding



BOOK  
NOW FOR  
SEPTEMBER  
2020



Contact us to find out more  
[www.littlefishesrowledge.org.uk](http://www.littlefishesrowledge.org.uk)  
01252 794617 \* St.James' Church, Rowledge  
[littlefishesnursery@gmail.com](mailto:littlefishesnursery@gmail.com)



## Morning Prayers

Every Wednesday via Zoom™  
from 9:00am for half an hour  
Email: [vicar@stjamesrowledge.org.uk](mailto:vicar@stjamesrowledge.org.uk) to join



St.James' Church  
Rowledge





## **Farnham Garment Alterations & Tailoring Service**

- Ladies & Gents clothing alterations
- Curtains & Soft Furnishings
- Suit / Wedding / Prom & Evening dresses
- One to One fittings by an expert
- Restyling & Repairs
- 1 hr & same day service available
- VIP & Home Visit Service (out of hours)
- Leather & PVC Repair
- Made to Measure Curtains, Upholstery & Garments (Limited options) ask for details

**5 Star express  
Gold service at  
20% discount**



With over 25 years of experience we can assure you that your garment will be in the best possible hands

01252 444640 [www.elitestitch.co.uk](http://www.elitestitch.co.uk)  
elitestitch12@gmail.com

No appointment required

12 Upper Church Lane, Farnham,  
Surrey, GU9 7PW

# *Always Glazing Works Ltd...*

Established 1984  
Genuine Local Family Run Business

**FREE ESTIMATES. NO JOB TOO BIG OR TOO SMALL**

- Table Tops and Safety Glass
- Manufacturers of Lead Lights & Double Glazed Units
- Suppliers & Installers of Pvcu Aluminium Windows & Doors
- Domestic, Commercial, Industrial & Insurance Work Undertaken
- Emergency Shop Front Replacement
- Greenhouse Glass



Unit 6, Farnham Business Centre  
Farnham Surrey GU9 7UP  
Tel: 01252 727262 Fax: 01252 737779  
[info@allwaysglazingworks.co.uk](mailto:info@allwaysglazingworks.co.uk)  
[www.allwaysglazingworks.co.uk](http://www.allwaysglazingworks.co.uk)



**FENSA**  
Registered Company

## METHODIST CHURCH

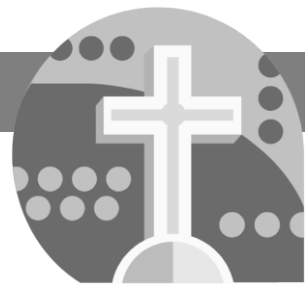

At the present time all activities at The Methodist Church are suspended. We hope that the church will be able to be open for private prayer as soon as we are permitted.

At the time of going to press we are still in talks and discussion about ways we might restart services in the Church. Once decisions have been made about how we can organise 'safe' seating and presentation of services we will publicise opening dates. In the meantime we have a prayer chain, led by Mike & Joyce, which can be accessed on 793363.

If you would like to speak to Philip, our minister, his number is: 01420 83167

**If you have any questions about activities at the Methodist Church, please** contact Aileen or David on 795438



**Do you know anyone who is grieving from bereavement and needs more support or time?**

Meeting weekly in Farnham, the group is supported by pastoral assistants and bereavement visitors attached to various Farnham Christian churches, and allows an opportunity for those who are bereaved and lonely to meet others who understand.

**Bereavement Café meet every Monday afternoon 3 - 4:30pm for tea and chat at**

**The Spire Café, Farnham United Reformed Church,**

**South Street, Farnham, Surrey GU9 7QU**

If you would like more details please contact Mary on **07999 368128** or [info@friendstogetherbereavement.org](mailto:info@friendstogetherbereavement.org)

There are also occasional evening groups for those who need to talk and share about a bereavement. Parents, Spouses, Children, Friends... Do you know anyone who is grieving and would like support?

**Contact Mary on  
07999 368128 for  
details during  
Covid-19**

You are also welcome to bring someone you know who may benefit from the support group, but not want to attend on their own. Accompanying friends are also very welcome.



## ONLINE

### Dance-Fitness Classes



**ZUMBA®**  
gold

Tuesdays,  
Thursdays and  
Fridays 10am



**ZUMBA®**  
fitness

Mondays 8pm  
Wednesdays and  
Saturdays 10am

**£3 per session**

Message for details of how to join.

Contact Alison Edwards 0781 397 6841

alizumba835@gmail.com

or ZumbaFun on

## CHIROPODIST / PODIATRIST

@ Holly Tree Doctors' Surgery  
Boundstone Road, Rowledge

# Yvette Mann

(and Associates)

B.Sc. Pod (hons), M.Ch.S., HCPC

Established since 1997

Treatment for all ages:  
routine chiropody, nail surgery,  
verrucae, foot and lower limb pain,  
insoles/orthotics.

*Please ring for an appointment:*

**01252 793183**

[www.yvettemannpodiatry.co.uk](http://www.yvettemannpodiatry.co.uk)

Also at Lucks Yard Clinic

**Milford: 01483 527945**

[www.lucksyardclinic.com](http://www.lucksyardclinic.com)

## ROBERT MOODIE

Master upholsterer

Since 1973



Is your sofa or perhaps your favourite chair  
In need of a little loving care?  
Don't push it aside or take to the 'tip'  
Just give us a ring and we'll mend it.

Loose covers or fitted, or down to the frame  
We will restore it, elaborate or plain  
Fabrics and braids for us to enhance  
Our craftsmanship's shown if given the chance.

Specialists in re-upholstery & loose  
covers

The Old Milking Parlour,  
Mellow Farm  
Dockenfield.

01428 712886

[hello@arfordupholstery.co.uk](mailto:hello@arfordupholstery.co.uk)

**Jane Ireland MCSP**  
**Chartered Physiotherapist**  
at  
**HOLLY TREE SURGERY**

42 Boundstone Road  
Farnham  
Surrey GU10 4TG

**Conditions treated include:**

Back Pain    Neck Pain  
Leg Pain    Arm Pain  
All Sports Injuries  
Back/Pelvic Pain associated with  
Pregnancy

For appointments:

**01252 793183**

**07950 186997**

[jane\\_physio@yahoo.co.uk](mailto:jane_physio@yahoo.co.uk)

[www.janeirelandphysiotherapy.co.uk](http://www.janeirelandphysiotherapy.co.uk)

## PRISM WINDOW CLEANING

Prompt and friendly local service.

Proprietor Dean Atkins.

[www.prismwindowcleaningltd.com](http://www.prismwindowcleaningltd.com)

Regular Service, Fully Insured

**Tel: 07768 986338**



## HEARING AID BATTERIES Sue Kelly

With the cessation of the Hearing Aid Clinic at Coffee Spot each month, if anyone needs batteries for their hearing aids, they should contact Audiology at The Royal Surrey hospital by telephone or email.

Give them your name, address and type of battery you need (see brown book). It is usually P13. The response is very good.

**rsc-tr.Audiology@nhs.net    01483 464108**



FOOD FOR ALL OCCASIONS

**TRACEY ELLIOTT**

**TEL: 07733 464867**

[www.toyourtaste.co.uk](http://www.toyourtaste.co.uk)

[food@toyourtaste.co.uk](mailto:food@toyourtaste.co.uk)

# OPTIPLAN KITCHENS

## BOOK YOUR FREE & EXCLUSIVE DESIGN CONSULTATION

SHOWROOM

EXCLUSIVE TO  
YOU

HOME

LET US COME  
TO YOU

ONLINE

INTERACTIVE  
DESIGN

HANDCRAFTED IN BRITAIN

Call **01252 345 588** or visit  
**optiplankitchens.co.uk**

Find us: 138 Farnborough Rd,  
Farnham, GU9 9BD.

## DAVE FITCHETT

GARDENING  
DECORATING  
FENCING, PATIOS and more  
**01252723389**

**07754775844**



## Have you ever considered Live-in Care as an alternative to residential care?



Live-in Care is when a professional and trained Carer lives with you in your home supporting you with your day-to-day needs. For many, having a Live-in Carer enables you to maintain your hobbies, interests and social life.

Tel **01428 690007** Email **enquiries@liveincare.ltd.uk**

**LIVE  IN  
CARE LTD**  
**24/7 PEACE OF MIND**  
**www.liveincare.ltd.uk**



# A Year of Rowledge Memories - Hard-back Book for Sale

**Limited  
Edition**

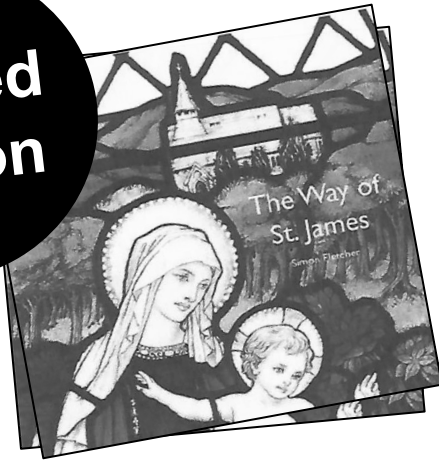

**“The Way of St James”** has been commissioned as a photographic record to mark the 150<sup>th</sup> Anniversary of St James’ Church - the parish church of Rowledge village, lying on the Hampshire/Surrey border.

This beautiful 60-page limited edition ‘coffee-table’ book, features stylish black & white photographs recording a whole year in the Parish, across a wide range of aspects of church life in the village and includes photographs of many residents of Rowledge. Photographs were taken by local resident, Simon Fletcher.

**Copies of this limited edition book are available to purchase for £30.**

To buy your copy, please contact the Parish Office on 01252 792402 or [admin@stjamesrowledge.org.uk](mailto:admin@stjamesrowledge.org.uk) or Mike Randall at [randallm\\_e@msn.com](mailto:randallm_e@msn.com)



**Copies of this limited edition book are available to purchase for £30.**

To buy your copy, please contact the Parish Office on 01252 792402 or [admin@stjamesrowledge.org.uk](mailto:admin@stjamesrowledge.org.uk) or Mike Randall at [randallm\\_e@msn.com](mailto:randallm_e@msn.com)

**Don’t delay - there are only 60 copies available.**

*All proceeds will go to support the work of the church in Rowledge.*



**St. James’ Church**  
Rowledge

## A Flora Westlake link to George Sturt (that Flora was probably unaware of.)

The incentive to write this short piece came for a chance remark from local historian, Roy Waight. He had been told that George Sturt probably visited his sister, Susan Sturt who had lived at Chanctonbury on Fullers Road. My research shows that could not have been entirely the case. Nevertheless, Roy has asked me to put pen to paper and share my work with you because surprising and somewhat pleasing links emerge.



By 1986, Flora Westlake had completed her short book **'the way we were'**. It was, and still is, an excellent narrative on some of the social history of Rowledge up to that time.

Flora had arrived in Rowledge sometime after her marriage to widower, Alan Robert Cecil Westlake at Hounslow in 1966. Alan, who had been a twice decorated Senior Civil Servant in India, working as a District Magistrate,

lived on Fullers Road in 'Chanctonbury'. This was then directly next door to our house to be, which was at that time known as Danford Cottage, now just Danford.

When Alan Westlake died in 1978, Flora, shown here in 1986, remained in Fullers Road, moving at some point into a small house that was built in or after 1972 between Chanctonbury and Danford Cottage. It was likely there that she researched and wrote her contributions to the Rowledge Review. Her book was based on these and published in 1986 by 'Rowledge Parish Church'.



One morning, without any notice, we awoke in a 'shaking' Danford to find that the house next door that Flora had lived in was being 'enthusiastically' demolished to be replaced by a larger version, now called 'Orchard Rise'. It was built for Simon Clegg, the future chief executive of the British Olympic Association.

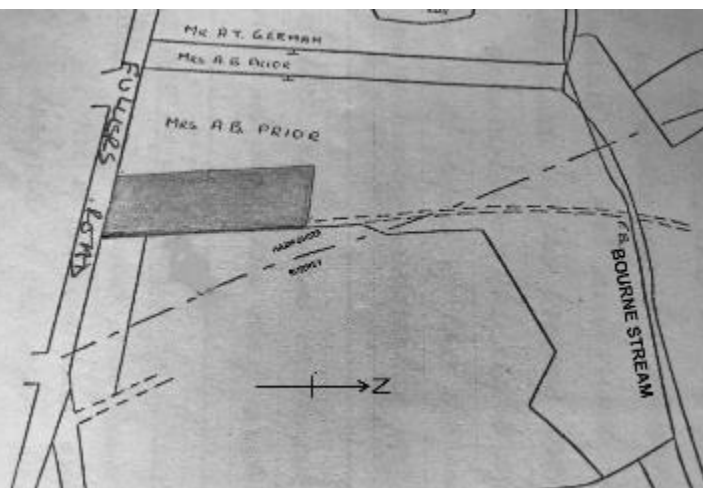

Before I briefly outline who Flora Westlake was, it is worth looking at the pre 1957 history of Chanctonbury, i.e. before the time Alan Robert Cecil Westlake and his first wife, Dorothy, apparently moved there. May 1957 was when the first registered owner, Mrs Ada Bessie Prior, died.

The deeds for our house, Danford (plot shown shaded) contain a plan that show two areas next door marked ‘MRS A B PRIOR’. Together, these were ‘Chanctonbury’ and they descended to the Bourne Stream.

Both Chanctonbury and our Danford Cottage (now Danford) were built in about 1929 by the Farnham builder, Archibald Thomas German who at that time is shown as owning the plot to the west of Mrs Prior’s Chanctonbury plot.

Who, then, was Mrs A. B. Prior (nee Firmin) and how did she come to be in Fullers Road?

The 1911 census for ‘Vine Cottage’ in Old Church Lane at Lower Bourne shows that Ada Bessie Firmin was a general domestic servant to **George Sturt** (shown as ‘coach-builder’) and to his sisters, spinsters Mary and Susan Sturt.

George Sturt	Head	47		single					Coach-builder	by
Mary Sturt	sister	56		single						
Susan Sturt	sister	45		single						
Ann Smith	aunt	79		single						
Alice Margaret West	visitor	24		single					Visiting Music Teacher	
Ada Bessie Firmin	servant	21		single					General Servant (Domestic)	

Ada Bessie Firmin was married to gardener, Alfred John Prior at St Andrews, Farnham in 1922. Her father, Edward Firmin, was a ‘coach wheeler’ in Farnham and as such almost certainly used the services of George Sturt, wheelwright.

If Alfred John Prior was not George Sturt’s gardener at Vine Cottage before 1922, he maybe was after his marriage to Ada Bessie Firmin in that year.



George Sturt, seen here in 1903 with ‘Mac’ (*photograph from Mark Westcott*), was not only a wheelwright and coachbuilder, he had taught at Farnham Grammar School and was a prolific and very successful author, writing about rural life and practices. He often used the pseudonym, George Bourne and is quoted in just about every historical reference to Farnham and the surrounding villages such as Rowledge.

It is possible to imagine that this picture (*from the Bourne Preservation Group*) of George at Vine Cottage with his sisters, Mary and Susan might have been taken by Ada (Bessie).





George Sturt's sister, Mary, died in 1922 leaving her wealth to George. His surviving sister, Susan and the Priors continued to live with him at Vine Cottage where they remained for two years after his death on February 4<sup>th</sup> 1927. His grave can be found, with difficulty, in the Green Lane Cemetery.

When George died he left his estate, worth £2682, to his sister Susan but his will, written a year earlier, also stated that should Susan predecease him then, amongst other bequests, he wished to leave four hundred pounds to his friend, Mrs Ada Bessie Prior.

On 12<sup>th</sup> March 1929, builder Archibald Thomas German sold the house that was already destined to be Chanctonbury and it was registered to Ada Bessie Prior. Electoral records show that Ada then moved there from Vine Cottage together with her husband, Alfred, and with George Sturt's surviving sister, Susan Sturt. As Ada had been a servant and her husband a gardener, it is unlikely that they would have saved enough of their own funds to buy the property. Danford Cottage, which was at the time was about the same size house as Chanctonbury but sitting on half an acre as opposed to several acres, sold for £950. Chanctonbury could well have cost twice that and I do not think it unreasonable to assume its purchase was, at least in part, funded from George Sturt's inheritance to his sister, Susan, with a view that he had wished Ada to benefit.

Susan Sturt died on April 1<sup>st</sup> 1935 and left £5,603, about £400,000 at today's value. Ada's husband, gardener Alfred John Prior was an executor of Susan's will. The 1939 register shows the Priors at Chanctonbury with Alfred as a gardener and Ada, a mushroom cutter.

When Flora Westlake moved to Chanctonbury in around 1966, she would likely be unaware that she was moving, albeit a touch obliquely, into a link with George Sturt, a writer of social history just as Flora later became. She might have discovered this later but if so, did not reveal it in her writings.

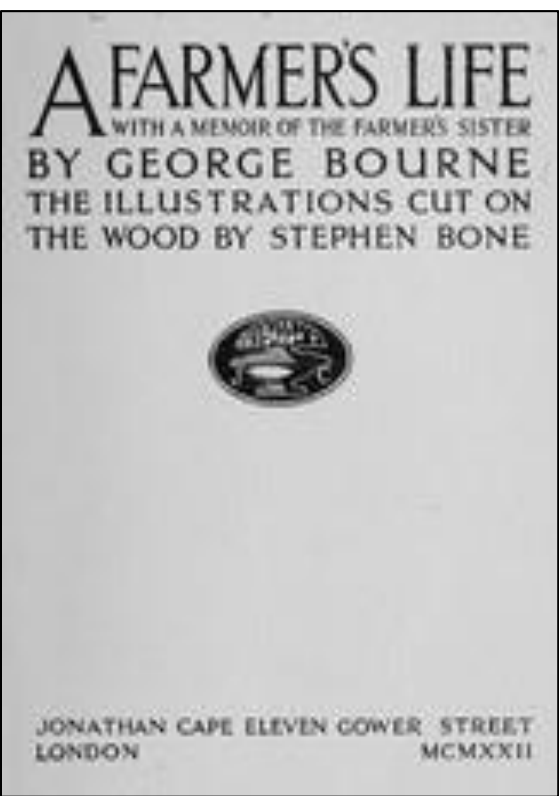

The house on Fullers Road was named Chanctonbury from the time the Priors and Susan Sturt moved there in 1929, but the reason why can only be speculative.

In George Sturt's (*George Bourne's*) book, '**A Farmers Life**' published in 1922, he recounts a tale that emanates from the farmers who worked the fields below Chanctonbury Ring on the South Downs. Maybe George and his sisters were fond of the area and Susan decided the house should reflect that?

Flora, likely unaware of any links, mentions George Sturt in her book: '*George Sturt, who lived in the*

*Bourne and wrote about this area, comments that all the charcoal burners he knew of were members of the extensive Parratt family.*

So, who was Flora Westlake? She was clearly an ardent researcher, for all her knowledge regarding Rowledge must have been collected between 1966 and 1984 and likely finalised in the short space between 1982 and 1985. 1982 was when the Revd. David Eaton arrived at St. James. He soon asked Flora to write articles for the Rowledge Review.

Flora Westlake was born at home in Hampstead on September 9<sup>th</sup> 1914. She was named Isabel Flora Beck.

Her father, shown here, was Horace Courthope Beck and he was born in 1873 into a family of manufacturing opticians in Stoke Newington. Both he and his brother, Conrad, continued the line, his brother longer than himself.

Flora's mother was Gundred Eleanor Trotter and she was born in Kensington in 1889. Her father was a Civil Engineer and author, editor of the 'Electrician'. Her mother was born in Dublin.

Horace and Gundred married in Kensington on May 13<sup>th</sup> 1913 and settled at 47, King Henry's Road, Hampstead, between Swiss Cottage and Primrose Hill. They had two children, Isabel Flora, born in 1914 and Eleanor born at end of 1916. Eleanor died soon after birth, and Isobel Flora becoming Horace and Gundreds' sole surviving child.



In 1924, when Isobel Flora Beck was nine or ten, the family moved from London to a magnificent farmhouse in the village of Fittleworth, Sussex. It was called Coates Farmhouse (now listed) and sat on two acres, almost certainly with a view across Fittleworth Common to Chanctonbury Ring on the South Downs. Chanctonbury, a name link to come later in her life, but at that time no more than a coincidence.



Her father, Horace, had by then clearly given up his role as a manufacturing optician for records, from about 1918, show that his interests were in history and archaeology. He became a Fellow of the Society of Antiquaries, F.S.A., and wrote papers on subjects such as **'Beads in European, African and Asian cultures'**.

Shipping records for 1924, 1925, 1926 and 1927 show that young Isobel Flora went annually with her parents to Algiers, presumably so that her father could continue his researches.

There are a final set of shipping records for a trip to Algiers between December 1938 and March 1939 when Isobel Flora accompanied her parents on her father's final trip to Algiers. Maybe this was a therapeutic journey for him. The 1939 register shows that, after his return, he was in the Graylingwell psychiatric hospital in Chichester where he died in 1941.

At some stage, Flora's mother, Gundred moved to or near Rowledge to be close to her daughter. She died in 1975 and her ashes were interned at St. James with her abode shown as Chanctonbury, Fullers Road.

What then of Isabel Flora Beck between the 1938/1939 record of her final visit to Algiers with her parents and her marriage to Alan Robert Cecil Westlake at Hounslow in 1966?

The 1939 register showed her role as a hospital almoner (social worker) at Southampton Hospital.

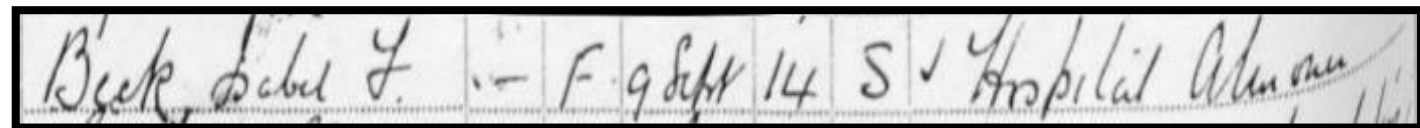

She would have been undertaking this role for several years although her occupation as listed on the 1938 and 1939 shipping records was shown as 'none'. Isabel Flora clearly had the ability to suspend her professional role for four months to help her ailing father.

In 1949 Flora was listed as living in Newcastle but residential records, other than later electoral registers in Chiswick, seem sparse.

Other records show that post WW2, Flora Beck, as she then became rather than Isabel Flora Beck, followed in her father's and maternal grandfather's scribing footsteps and wrote several papers and books, including some for the Hospital Almoners' Association. She was listed as an associate of the Institute of Hospital Almoners and a social work researcher working for the Nuffield Department of Medicine when, in 1946 during the formative years of the NHS, she **wrote 'The Almoner: A Brief Account of Medical Social Service in Britain'**. Then in 1947 Flora shared the writing of **'Social Service for a Medical Ward'**. In 1956 she wrote **'Ten Patients and an Almoner'**.

I imagine if she were alive today, Flora would be tempted to write again, this time focussing on the stresses placed on the current Social Services by funding constraint. Flora's ability to research, as shown by her work for the Nuffield and others, will have stood her in good stead for her future research in Rowledge. She would know what questions to ask and where to find those who knew some of the answers.

When we moved to Danford from the Crondall side of Farnham in August 1996, Flora was in hospital, possibly with a serious lung condition and only very briefly returned home to the house next door. We glimpsed her, just once, but regretfully never spoke. She died on January 24th 1998 at Frimley Park hospital having lived out her days in Loadhams nursing home, Waverley Lane. The transcribed records for St. James' Church show her burial on May 5th 1998. Presumably this was for the internment of her ashes.



There are two links between the homes of Flora Westlake and George Sturt.

The first, as I have pointed out, is that her first Rowledge home, Chanctonbury, was built in 1929 and the Priors and George's sister, Susan Sturt were the first to live there and name it. Over three decades later, Flora Westlake moved there.

The second link is that George Sturt's beloved Bourne Stream links Chanctonbury to his Bourne Vine Cottage. It starts from near Lodge Pond in Alice Holt, under Fullers Road and runs close to 120 metres of the ground at the bottom of the garden of Chanctonbury. It then flows under Manley Bridge and winds through the Bourne valley to the land below Old Church Lane and under Vicarage Hill close to George Sturt's Vine Cottage. The short stream eventually emerges into the river Wey at Moor Park, an area mentioned by William Cobbett in his book, '**Rural Rides**'. Referring to his childhood and the wooded, sandy ridge (now built on) above the River Wey, Cobbett wrote: '*We went to this Bourn(e) in order that I might show my son the spot where I received the rudiments of my education.*' One can be sure that George Sturt, and maybe his sisters, followed the Bourne stream north east to the Wey and up to 'Cobbett's Ridge', surely glimpsing the brilliant blue flash of a Kingfisher just as can occasionally be seen today. They may have also followed the stream south west and walked close to the land that became Chanctonbury. Is this maybe where the rumour that George had visited his sister there came from? We can be certain that nearly half a century later, Flora would have often walked down through the land of Chanctonbury. She maybe trod in the steps of Susan Sturt on her way down to the Bourne Stream and like Susan, watched it meandering on its way to the Bourne and to where George Sturt had been inspired by it. Maybe, a century earlier, William Cobbett also had been inspired by the evocative stream.

St. James Sunday School teacher, Rose Althea Lane, who lived in Rowledge for 79 years and whose memories of the village were invaluable to Flora's research, wrote, when reminiscing about Rowledge, that she believed a small old cottage, just upstream from Chanctonbury, was once occupied by 'Old Cobbett, somehow (she believed) connected to the Cobbett of **Rural Rides**'. Rose seemed to have been unaware of the presence of Susan Sturt living in Fullers Road.

Flora benefitted from the memories of many in the village, including the reminiscences of Rose Lane, as well as the earlier writings of Florence Parker, daughter of the Revd. Arthur Parker who was first vicar of St. James. She gathered a fascinating social history record, not just for the village but for all historians. I believe if Flora knew that she had lived, even though obliquely, in a piece of George Sturt history she would have been delighted. Maybe she did know, but even if not, it is peripheral and adds little to her own narrative. Flora Westlake's were very relevant pieces in the slowly growing jigsaw of the social history of Rowledge and its' surroundings. Roy Waight has now brilliantly explored further and comprehensively developed the story in his book, '**Rowledge, Remote from Civilisation**'.

# Nigel Gaymer

## Interior & Exterior Decorating

For a free estimate with full references  
please contact Nigel on:

07951 558443

01252 711260

[nigelgaymer@btinternet.com](mailto:nigelgaymer@btinternet.com)

## WRECCLESHAM TENNIS CLUB

Small enough to be mega friendly  
Large enough to offer some great tennis.

4 Hard Asphalt Courts (3 floodlit)

New clubhouse

Coaching available

LTA Tennismark Accredited

Men's, Mixed & Ladies' teams

Social tournaments & events

Members' Wimbledon Draw Ballot

Great value membership costs

Find us at Riverdale, Wrecclesham, GU10 4PJ (the other side of the A325)

**[www.wreccleshamtennis.org.uk](http://www.wreccleshamtennis.org.uk) or**

**email: [membership@wreccleshamtennis.org.uk](mailto:membership@wreccleshamtennis.org.uk)**



St. James' Church  
Rowledge

# Annual Meeting of Electors & Parochial Church Meeting

## Sunday 18th October at 3:30pm

All those on the Electoral Roll of the Parish of Rowledge are invited to attend this year's annual meetings which will take place online via Zoom. These meetings appoint Churchwardens and receive reports on the activities of the Parish Church over the last 12 months.

For details on how to join, please email:  
[vicar@stjamesrowledge.org.uk](mailto:vicar@stjamesrowledge.org.uk) or phone: (01252) 792402



## You don't see this very often!

During a friendly bowls match at Rowledge Bowling Club in September, three bowls ended up touching the Jack.

The green bowls were Phil Thomas', and the black, Tony Carpenter's.

Although logic would say that green should win the end - two against one - the rule stated the end was drawn.

Phil and Tony are still talking!



Whilst talking Bowls, Club Captain, Ken Wickenden, said in his email to members: "I trust that all those who availed themselves of the club's playing facilities over the past few weeks, for the most part in excellent weather conditions, have enjoyed playing on a superb pair of rinks (with our competition finalists enjoying a third!) prepared for us by Peter Ludford and his team."

As the season comes to an end the Club wishes to thank Peter for keeping the green in tip-top condition and Terry Cannon and the rest of Peter's helpers for the planned work over the closed season, so it's ready for the new season next Spring.



## New Pilot Online Sessions to Support Patients at Home

Local charity Phyllis Tuckwell Hospice Care is launching a pilot online version of a selection of its Living Well sessions, to connect patients who have been and still are unable to come to the Hospice or Beacon Centre during the pandemic.

Phyllis Tuckwell's Living Well service helps patients and their families to manage the impact of their illness, and cope with living their everyday life. It offers a range of therapeutic sessions to promote physical, emotional and spiritual wellbeing. These are usually held at the Hospice in Farnham and the Beacon Centre in Guildford, but the groups were suspended when lockdown was introduced, so patients could only be supported from a distance by phone or video calls. Now, however, five of the sessions - Tai Chi, Relaxation, Carer Support, Reminiscence and the Rainbow Project - are being trialled on Zoom.

Each session will be offered to a maximum of eight participants, with small groups enabling the staff running the session to ensure that everyone is included and being supported throughout the whole session.

"We held our first Tai Chi session last week and it went really well," said Phyllis Tuckwell Physiotherapist Sue O'Brien. "Everyone was really pleased to be part of a group again, and at the end one of the participants said they had felt very isolated during lockdown, and asked if they could stay on and have a chat with the others in the group - so as well as being a way in which we could run the Tai Chi session, it also became a valuable communication tool to help combat loneliness."

The pilot will test a range of different sessions. Some will be mainly staff-led, such as Relaxation, which helps participants to relax their body and then takes them through a guided meditation where they imagine walking along a beach, for example. Others will involve more discussion, such as Reminiscence, where participants share memories with each other, based around a subject such as holidays or their childhood.

"Sharing memories and talking about our past has positive effect on self-esteem," says Phyllis Tuckwell Health Care Assistant Nick Ritchie. "Sometimes people who are ill start to define themselves by their illness, so to talk about past experiences and achievements helps them to re-establish their own identity and build their confidence."

Another session which is starting up in September is the Rainbow Project. Staff will send out a pack of coloured paper, with each colour being allocated a subject: red is love, orange is memories, yellow relationships, green nature, blue places and purple music. Patients are then asked to create something for each subject, using any media they like - for example they could knit love hearts, draw a picture of a happy memory they have, or take a photo of a place they love to

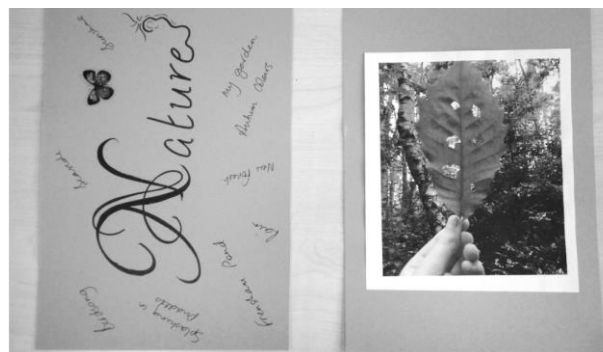

visit. They are then asked to bring their creations to the groups and share it with the others there, talking them through what it represents and means to them.

As well as supporting its patients, Phyllis Tuckwell will also offer a series of weekly sessions for patients’ carers, giving them information about the support that is available for carers in Surrey and Hampshire, and offering them relaxation, meditation, Tai Chi and table-top gardening sessions to help them manage their own emotional health and wellbeing.

In addition to these online sessions, Phyllis Tuckwell’s Living Well staff have also put together Resource Packs, which they are delivering to patients at homes. “Because of Coronavirus restrictions, our patients can’t come to Day Hospice sessions as they used to,” explains Nick, “so we’re taking Day Hospice to them!” The packs include a mug with sachets of tea and coffee, biscuits, complementary therapy creams and oils, and leaflets which are specific to the individual patient. “If someone is feeling anxious or worried, we will put in a relaxation leaflet, for example,” says Nick. “When we drop the packs off, we can see our patients too, so we can assess how they are in person and not just over the phone. We really hope that these virtual sessions and resource packs bring our patients, carers and staff together, and help our patients and carers to feel supported.”

To find out more about Phyllis Tuckwell’s Living Well sessions and the care they offer, visit [www.pth.org.uk/living-well-service](http://www.pth.org.uk/living-well-service).

# 4 FOUR SEASONS MARQUEES

BEAUTIFUL MARQUEES FOR EVERY OCCASION



For more information  
Call

01420 488477

[www.FourSeasonsMarquees.co.uk](http://www.FourSeasonsMarquees.co.uk)

# Jane Stockdale

## HOME COOKING

- for all occasions

Dinners, Luncheons, Buffets,  
After Service gatherings,  
Tea parties, Children’s parties,  
cooking for the freezer,  
individual dishes.



SPECIALISING  
in  
CAKES &  
CANAPES

Please call

01252 723 161 or 077 75 69 69 18

## HOME COMPUTER SUPPORT & TUITION - " My PC Home Help ! "

*Whether a Home or Small Business user. I can Help with your PC Problems !*



- Friendly, Professional Support for PC, iMac & iPad ✓
- Computer Health Checks including Virus Removal ✓
- Hardware & Software Maintenance and Upgrades ✓
- Broadband Wired & Wireless Solutions and Setup ✓
- One To One Home Tuition for All Ages & Abilities ✓
- I Supply, Install and Support PCs, iMacs and iPads ✓

*Moving to a New Computer ? - I'll transfer absolutely everything for you !*

**Contact Richard Siers on Bentley (01420) 22844**  
**or e-mail: [enquiries@myPChomehelp.co.uk](mailto:enquiries@myPChomehelp.co.uk)**

visit: [www.myPChomehelp.co.uk](http://www.myPChomehelp.co.uk)

The "What's happening in Rowledge...  
...and who to contact?" section

ROWLEDGE VILLAGE EVENTS CALENDAR 2020



# VERY IMPORTANT!!!

## ALL ROWLEDGE Event Organisers!!!!

Please email the Editor with event dates for 2020, so we can include it in all future issues of the Rowledge Review. Email: [rowledgereview@yahoo.co.uk](mailto:rowledgereview@yahoo.co.uk)



## Rowledge Activities - Weekly Calendar



Time	Group	Age	Venue
<b>Children's Events</b>			
<b>Mon-Fri</b>			
09.00-15.30	Rowledge Playgroup	2-4	Village Hall
09.00-15.00	Little Fishes Nursery School	2-4	St James Church
<b>Tuesday</b>			
17.00-18.15	Beavers	5-8	Village Hall
18.15-19.30	Cubs	8-10	Village Hall
19.30-21.15	Scouts	10-14	Village Hall
<b>Wednesday</b>			
09.15-11.00	Baby & Toddler Group (term time)	0-4	Village Hall
15.00-19.30	Ballet	3-13	Village Hall
16.45-18.00	Octave children's choir	7+	St James Church
17.00-18.00	Rainbows	5-7	Methodist Hall
18.30-20.00	Guides	10-14	Methodist Hall
19.00-20.30	#hungry (youth group)	11-16	St James Church Hall
<b>Thursday</b>			
18.15-19.45	Brownies	5.30-7	School Hall
<b>Friday</b>			
16.00-18.30	Ballet	13-adult	Village H



Contact details  
are in the Village  
Directory - in the  
centre pages of  
the Rowledge  
Review.

## Adults' Events

<b>Monday</b>			
08.30-09.00	Morning Prayers		St James Church
14.00-16.00	Steady Steps		Village Hall
19.30-21.00	Bruce Yoga		Village Hall
19.30-21.30	Pilates		Village Hall
<b>Tuesday</b>			
09.30-11.30	Ballroom Dancing		Village Hall
09.30-10.30	Zumba Gold (term time only)		Village Club
10.40-11.40	Pilates		Rowledge Club
14.00-17.00	Quilters (fortnightly)		Methodist Hall
19.00-20.00	Pilates		St James Church Hall
19.30-21.15	Community Choir		Frensham Heights School
19.45- 22.00	Womens Institute (3 <sup>rd</sup> T		The Rowledge Club
20.00-22.30	After 8 ladies group (1 <sup>st</sup> day)		Homes
<b>Wednesday</b>			
08.30-09.00	Morning Prayers		St James Church
10.30- 12.00	Mother's Union		St James Church
14.00-15.00	Nordic Walking		Forest (St James gate)
14.00-16.00	Cameo Singers (2 <sup>nd</sup> &4 <sup>th</sup> Wed)		Methodist Hall
15.00-16.00	Healing (1 <sup>st</sup> Wed)		Methodist Church
19.00-22.15	Bridal Singers		Village Club
19.00-20.00	Pilates		St James Church
19.45-22.30	Rowledge Club		Village Hall
<b>Thursday</b>			
09.00-16.00	Teachers		Methodist Hall
10.00-12.00	Art Club		Village Hall
12.30-1.30	Luncheon Club (last Thursday)		Methodist Hall
14.30-15.30	Steady Steps		Village Hall
18.00-19.00	Boot Camp		Village Hall
18.00-19.15	Gardening Club (2 <sup>nd</sup> Thursday)		Village Hall
18.00-19.15	Bootcamp		Village Hall
20.30-23.00	Men's Group (3 <sup>rd</sup> Thursday)		Hare and Hounds
<b>Friday</b>			
08.30-09.00	Morning Prayers		St James Church
09.00-12.00	Coffee Spot		Village Hall
16.00-18.30	Ballet		Village Hall
19.00-20.00	Choir practice		St James' Church
<b>Sunday</b>			
19.45-20.45	Ballroom Dancing		Village Hall

# ROWLEDGE DIRECTORY – 2020



## ST JAMES' CHURCH – Church Lane, Rowledge, GU10 4EN

Vicar	Revd Russ Gant	01252 792402	vicar@stjamesrowledge.org.uk
Churchwarden	Lesley Voice	01252 794579	lesleyvoice@rocketmail.com
Churchwarden	Mike Randall	01252 792007	randallm_e@msn.com
<b>PARISH ADMIN</b>	<b>Hannah Epps</b>	<b>01252 792402</b>	<b>admin@stjamesrowledge.org.uk</b>

### Pastoral Assistants

Parish Friends Coordinator	Elaine Andrews	07928 208 590	daveandelaine@hotmail.com
----------------------------	----------------	---------------	---------------------------

### Youth Work

Children's Minister	Adele Regan	07791 103 895	Adele.regan@stjamesrowledge.org.uk
Little Fishes Nursery	Judith Parish	01252 794617	littlefishesnursery@gmail.com

### Church Officers and Group Leaders

PCC Secretary	Karen Fewster	01252 795169	karenfew@gmail.com
Hon Treasurer	Andrew Fewster	01252 795169	andrew.fewster@gmail.com
Director of Music/Organist	Vacant		
<b>Planned Giving</b> (M'ship)	Mike Randall	01252 792007	randallm_e@msn.com
<b>Planned Giving</b> (Admin)	Andrew Fewster	01252 795169	andrew.fewster@gmail.com
Electoral Roll Officer	David Pennington		david@dpcon.eu
Cathedral Link	Colin Honey	01252 794317	
Church Cleaning Team	Maria Doland	01252 793984	
Coffee Rota	Jan Clarke	01252 793661	jan.8@btinternet.com



### Rowledge Review

Editor/Creative	Tony Carpenter	01252 793060	rowledgereview@yahoo.co.uk
<b>SEND ARTICLES TO:</b>	Editor	-	rowledgereview@yahoo.co.uk
Advertising	Maggie Blyth	01252 790660	maggie.v.blyth@gmail.com
Distribution	Church Office	01252 792402	admin@stjamesrowledge.org.uk

### Church Charities

Children's Society	<i>Vacant</i>		
Christian Aid, Rowledge	Elaine Andrews	07928 208 590	daveandelaine@hotmail.com
USPG	Janet Cunningham-Christie	01428 609290	





## METHODIST CHURCH, Chapel Road, Rowledge. GU10 4AP

Minister	Rev'd Philip Simpkins	01420 83167	
Office	-	-	aileen.m.ashby@gmail.com
Church Steward	Aileen Ashby	01252 795438	aileen.m.ashby@gmail.com
Church Steward	Anne Chuter	01252 792685	
Church Steward	Paul Fry	01252 794748	Paul.fry@btinternet.com
Church Steward	Alison Morrice	01252 794471	
Lettings / Hall Bookings	Lynda Godfrey	01252 792479	
Luncheon Club	Aileen Ashby	01252 795438	aileen.m.ashby@gmail.com
Healing Service	Joyce Williamson	01252 793363	jm.williamson@homecall.co.uk

### Activities for Children

Little Fishes Nursery School	Judith Parish	01252 794617	littlefishesnursery@gmail.com
Baby & Toddler Group	Miranda Billowes	07977 539 315	rowledge toddlergroup@gmail.com
Rowledge Playgroup Pre-School	April Pegler	07751 366392 or 07806 784035	rowledgeplaygrp@aol.com
Ballet	Maureen Hamilton	01428 656402	maureen@almondndance.com
Playball	Nicola Stubberfield	07919 123008	playballsurrey@gmail.com
Beavers	Rachel Mason	01252 794195	rkmason1904@gmail.com
Cubs	Richard Baines-Walker	07968 587642	richard.banes-walker@struttandparker.com
Scouts	Colette Grist	07879 406 926	colette.grist@yahoo.co.uk
Brownies	-	-	rowledgebrownies@gmail.com
Rainbows and Guides	Rachel Britton	01252 591631	rachel_vasey@yahoo.com
Rowledge After School Club	School Office	01252 792346	
Bootcamp	Olivia Gardner		olivia_g@hotmail.com
Roller skate club	Adam Collis		rowledge@skateclubs.org
Rowledge Football Club	Catherine Greenwood	01252 781785	catherine.greenwood@tribalgroup.com

### Schools

Rowledge C of E Primary School Head Teacher	Sarah Oliver	01252 792346	admin@ rowledge.hants.sch.uk
Co-Chair of Governors	Helen Davies		
Co-Chair of Governors	Tom Nixon		
Friends of, Chair	Caroline Eaton	07710 463311	caroline_eaton@me.com
Frensham Heights School	Rick Clarke - Head	01252 792561	admin@frensham-heights.org.uk

### Village

Residents' Association	Jeff Ward	01252 795773	wardjeff99@btinternet.com
Village Fayre Chairman	Kelly Taylor	07940 549102 01252 790722	Les_taylors@yahoo.co.uk
Tree Warden	Brian Greig	01252 793762	

### Village Hall

Chairman	Richard Baines-Walker	07968587642	
Treasurer	John Phipps		treasurer@rowledgevillagehall.com
Secretary	Karen Fewster	01252 795169	karenfew@gmail.com
Bookings	Susie Duffy		bookings@rowledgevillagehall.com

### Police

Surrey	101	Hampshire	101
--------	-----	-----------	-----



### Charity Representatives

Cancer Research	Jenny Crawford	01252 793517	
RNLI	Nigel Cuthbert		rnli.farnham@btinternet.com
Save the Children / CHIKS	Robin Radley	01252 794212	robin.radley1@btinternet.com

### Social Groups

After 8 Group for Women	Sue Gardner	01252 793903	susan@gatec.co.uk
Alice Holt Women's Institute	Grada Helsdon	01252 727824	aliceholtwi20@gmail.com
Art Club	Roger Warburton	01252 793813	rwarburton@btinternet.com
Coffee Spot	Liz Thomas	01252 793802	liz_thomas118@yahoo.co.uk
Community Choir	Edwin Rolles	01420 541966	edwinrolles@hotmail.co.uk
Quilters	Sue Stephens	01252 794375	suestephensuk@btinternet.com
Patchers	Sandra Bigg	01252 792082	sandratbigg@hotmail.com
Farnham Conservatives	Wyatt Ramsdale	07771 674634	Wyatt.Ramsdale@surreycc.gov.uk
Qigong	Julian Jaffe		Julian.jaffe@computer-agents.com

### Sports /Activity Groups

Badminton Club	Jeff Kelly	01252 625612	jeffmkelly@virgin.net
Ballroom Dancing	Angela Cobley	07732 556170	angelaschoolofdancing@hotmail.com
Bowling Club Captain	Ken Wickenden	01252 794413	twix.crossroads@talktalk.net
Bowling Club Chairman	Colin Smith	01252 792453	colin.smith747@btinternet.com
Bowling Club Secretary	Sue Stephens	01252 794375	suestephensuk@btinternet.com
Bridge Club			Occasionally in Rowledge Review
Cricket Club Chairman	Carl Baker	07768 325701	carl@carlbaker.co.uk
Cricket Club General Secretary	Lynley Griffiths	01252 710534	lynley.griffiths@talktalk.net
Nordic Walking	Sue Gardner	01252 793903	susan@gate.co.uk
Pilates/Yoga/Zumba	Hannah Epps	07855 291833	hannah@farnhampilates.com
Yoga	Bruce Hawkins		bruceyoga@hotmail.com
Steady Steps	Louise Neave	07875 330440	louise@steadystepsphysio.co.uk
Tennis Club	Kelly Taylor	07940 549102	info@rowledgetennis.org.uk
Rowledge Gardening Club	Roy Gardner	01252 793903	chairman@rowledgegardeningclub.org.uk
Zumba	Alison Edwards	0781 397 6841	ianandalison1@tiscali.co.uk
Hand-bell Ringers	James Morrice	07854 382598	j.morrice@hotmail.com

### Welfare

Care Farnham	David Ashby	01252 795438	
Care Farnham	Duty Officer	01252 716655	
Phyllis Tuckwell Support Group	Mandy Main	07904 531337	
Doctors' Surgery	Holly Tree Surgery	01252 793183	
Chiropractor	Anna Maynard	01252 793183	
Surrey Victim Support	[24 hr]	01483 770457	
Hampshire Victim Support	[24 hr]	01252 342777	

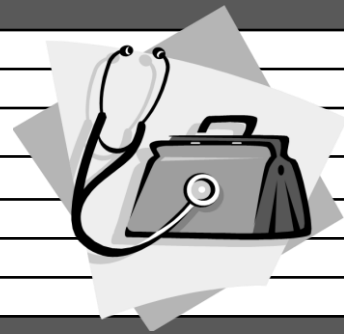

### Councillors

Surrey County Council	Wyatt Ramsdale	07771 674634	wyatt.ramsdale@surreycc.gov.uk
Hants County Council	Mark Kemp-Gee	01420 563550	marknkempgee@aol.com
E Hants District Council	Ken Carter	01420 22576	Ken.Carter@easthants.gov.uk
Farnham Town Councillor	Paula Dunsmore	01252 710009	Paula.dunsmore@farnham.gov.uk
Binsted Parish Coun. [Clerk]	Sue Hodder	01420 520692	clerk@binstedparishcouncil.org.uk
Binsted Parish Coun. [Dep Clerk]	Karen Ray		depclerk@binstedparishcouncil.org.uk www.binstedparishcouncil.com
Binsted Parish Coun. [Chair]	Ron Neil		r.neil@binstedparishcouncil.org.uk
Binsted Parish Coun. [V.Chair]	Debbie Brooks		d.brooks@binstedparishcouncil.org.uk

## Men on The Rowledge War Memorial

by Neil Pittaway

The first baptism record in this month's 'Memorial' entry is of particular interest in the history of St. James. The 1861 baptism shown was conducted by the Revd. Henry Richard Julius. As chronicled in Roy Waight's 'Remote from Civilisation', the Revd. Julius was the vicar of St. Peter's, Wrecclesham and one of the prime instigators of St. James at Rowledge which was to have its foundation stone laid in 1869. He was also to be the father in law of the first vicar of Rowledge, the Revd. Arthur William Parker who served at St. James for over forty years.

Without access to family diaries, there are some things to take at face value. The census records for the Bryant family indicate that between 1890 and the early 1900s they fluctuated at least twice between Croydon and Rowledge. It is clear that Louis Bryant's parents had come together in Croydon to marry but as his father came from Rowledge and his mother from Northants we can only offer inspired guesses at reasons for this.

**Louis Smith Bryant 1892-1917**  
**Private 2<sup>nd</sup>, 8<sup>th</sup>, and 6<sup>th</sup> Battalion The**  
**Queen's. Royal West Surrey Regiment.**  
**G/50**

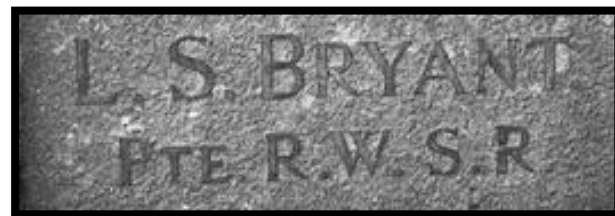

Louis Smith Bryant was born in Rowledge in early 1892. His parents were James and Emma (nee Wilmott) Bryant. Father James, who by 1911 was a garden and farm labourer, was born in Rowledge in 1861 and baptised (pre-St. James) in Wrecclesham by the Revd. Henry Richard Julius. 'Smith' was the first name of his maternal grandfather, Smith Willmott.



1861	June 2 <sup>nd</sup>	James	James	Bryant	Rowledge	Labourer	MR Julius
No. 1			Eliza				

**Baptism of James Bryant, Louis's father, Wrecclesham June 2<sup>nd</sup> 1861**

Mother Emma Wilmott was born in Northamptonshire in 1866 and she married James in Croydon's registry office in 1890:

1890. Marriage solemnized at the Registrar's Office in the District of Croydon in the County of Surrey								
No.	When Married.	Name and Surname.	Age.	Condition.	Rank or Profession.	Residence at the time of Marriage.	Father's Name and Surname.	Rank or Profession of Father.
1890	3 <sup>rd</sup> September 1890	James Bryant	23 years	Bachelor	Team Chandler's Assistant	62 Linnworth Place Croydon	James Bryant	General Labourer
		Emma Wilmott	23 years	Spinster		28 St. John's Green Croydon	Smith Wilmott	Carpenter Journeyman
Married in the Registrar's Office according to the Rites and Ceremonies of the by Certificate before us,								
This Marriage was solemnized between us,			In the Presence of us,			Signed and sealed by me,		
James Bryant			The Registrar			Edmund Bailey		
E. Wilmott			A. Clapham			Thomas G. Smith		

**Louis's parent's marriage, Croydon September 3<sup>rd</sup> 1890**

It is not clear what took either James or Emma to Croydon but maybe it was in search of work. At his marriage, James is seen to be working in a Corn Changers and a year later in the following 1891 census he is a carman, possibly working on the railway or as a carrier, as was his father in law.

James Bryant	Head	M	24		Carman	Surrey. Rowledge
Emma do	Wife	M	26			Northampton - Woodford
Walter James do	Son	M	5			Surrey. Croydon

1891 census for Louis's parents, Croydon with first son, Walter James.

James Bryant	Head	M	40	9	General Labourer	Worben	Surrey. Rowledge
Emma	Wife	M	35				Northampton - Woodford
James	Son	M	10				Surrey. Croydon
Louis	Son	M	9				do Rowledge
Arthur	Son	M	7				do do
Bertha	Daughter	F	5				do do
Harry	Son	M	2				do Croydon

1901 Croydon census for the Bryant family. Louis aged 9.

It would seem, as shown in this 1901 Croydon census, that Louis's parents returned to Rowledge for his birth in 1892, stayed for that of his brother Arthur in 1894 and for sister Bertha in 1896. Their return to Croydon for the birth of son Harry was by 1899. Harry is shown here as aged 2 and born in Croydon, Louis aged 9.

The 1911 census shows the family were likely firmly back in Rowledge from at least 1903 for the birth of Louis's youngest sister, Hilda. The family were living at Spring Cottage which was built around 1850 and is still on the corner of Manley Bridge Road and Chapel Road where they may have lived since the birth of their last daughter, Hilda in 1903.

James Bryant	Head	50	Married	6	6	Labourer - Farm Gardener	Rowledge, Surrey
Emma Bryant	Wife	45	Married	2	6	Chambermaid	Northampton - Woodford
Walter James Bryant	Son	20	Single			Gardener	Croydon - Surrey
Louis Smith Bryant	Son	17	Single			Gardener	Rowledge - Surrey
Arthur William Bryant	Son	14	Single			Grocer Assistant	Rowledge - Surrey
Bertha Bryant	Daughter	15	Single			Wash at Home	Rowledge - Surrey
Harry Bryant	Son	11	Single			School	Croydon - Surrey
Hilda Susan Bryant	Daughter	8	Single			School	Rowledge - Surrey

Louis, 19 and a gardener with parents and siblings, 1911 Spring Cottage, Rowledge

The military records for Louis Smith Bryant seem to have been lost in the fire of 1940. We know from his death record that Louis enlisted in Guildford, presumably straight into the Royal West Surrey Regiment, The Queens (R.W.S.R.) but we cannot be sure.



We also know from Louis's medal records that he was awarded the 1914-15 Star and embarked for France on June 1<sup>st</sup> 1915. He served in the 6<sup>th</sup>, 8<sup>th</sup> and finally the 2<sup>nd</sup> Battalions of the R.W.S.R.

G/50 ✓	Pte	✓ BRYANT	LEWIS	6th. RWS. G/50 Pte.
			SMITH	8th. RWS.
				2nd. RWS.

Excerpt from the Medal rolls showing Lewis's three Battalions

### WW2 Medal Card for Louis Smith Bryant Showing the 1915 Star

Name <i>BRYANT</i> <i>Lewis. S.</i>		Corps <i>The Queens R</i>	Rank <i>Pte</i>	Begtl. No. <i>G/50</i>
Medal	Roll	Page	Remarks	
VICTORY	<i>E/1/101 B.</i>	<i>9.</i>	<i>Died 26-10-17</i>	
BRITISH	<i>do</i>	<i>do</i>		
<i>15</i> STAR	<i>E/1/2 B.1</i>	<i>3.</i>		
Theatre of War first served in		<i>(1) France</i>		
Date of entry therein		<i>1-6-15.</i>		

Without a military record it is not clear which actions Louis was involved but he likely fought in his first battle at Loos in 1915, on the Somme in 1916, and Arras in 1917. We know from where he fell that he fought at the third battle of Ypres, Passchendaele, recorded as having been one of the costliest battles of the War and certainly fought in some of the worst conditions.



The appalling mud and devastation of Passchendaele, Ypres, 1917.

Louis's 2<sup>nd</sup> Battalion was involved on an attack on Gheluvelt when he fell on October the 26<sup>th</sup> 1917 just three weeks short of the end of that terrible Passchendaele campaign. He was twenty five.

Like thousands of other soldiers lost in those dire conditions, Louis was never recovered and has no known grave.

Louis Smith Bryant is remembered on panels 14 to 17 of the Wall Memorial at the Tyne Cot memorial near where he fell.

It is certain that Louis Smith Bryant had fought in several of the war's hardest campaigns. When he died in October 1917, Louis's effects showed that his mother received a total of over £27 which was a sum indicating that Louis had been a soldier for some time:



The Tyne Cot Memorial Wall near Ypres, Belgium

Bryant Louis Smith	2/10/17 No Surrey Regt V6 g. 50	26.10.17 France 1.18	12 17 9	12 17 9	12.1.18	27.2.18	Mrs. E. Bryant Emma	12 17 9
<div style="border: 1px solid black; padding: 5px;"> <b>WAR GRATUITY.</b>  1918  Transfer 52.26/2  Regd. Paper 2/10/17  Serial No. 1/1/17 </div>			14 10 -	10/11/1917 Mrs. E. Bryant Emma 14 10 -				

Effects record for Louis Smith Bryant paid to his mother.

This record shows that Louis's mother, Emma, seemingly as a dependant, was in receipt of a pension in relation to her son. Four shillings a week which went up to five shillings (25p) from November 1918.

Date and cause of death	26.10.17. Killed in action		
Dependant	Mrs Emma Bryant		
Address	Spring Cottage, Howledge, Lamberhurst, Surrey		
Relationship	Mother		
Pension	4/-	5/-	a week from 4.6.18. 6.11.18
Date awarded	8.6.18	If refused {	
Papers	12.12.18.	reason {	

Louis's father, James died in 1942 and his mother Emma in 1944. They are buried together at St James, Rowledge and were by then living in Pontypool, in what is now the High Street, once known as Pontypool Road.

James Bryant No. 30 7/32	Pontypool. Rowledge	August 29 <sup>th</sup> 1942	81 yrs	A. D. Dault	No 74 Double Dault
--------------------------------	------------------------	------------------------------------	-----------	-------------	-----------------------------

Burial records for Louis's parents at St James, 1942 and 1944.

Emma Bryant. See No 30 No. 66 7/38	Pontypool Rowledge	Oct. 16 <sup>th</sup> 1944	49 yrs	A. D. Dault	
---	-----------------------	-------------------------------	-----------	-------------	--

Louis's youngest brother, Harry, also served in the latter stages of the War with the Royal West Surrey Regiment and thankfully survived to lead a successful life, marrying Florence Anderson, raising five children and becoming the manager of a chocolate importers in the Croydon area. He is remembered on the church porch memorial to 'Those Who Served'. He was just 18 at the end of the War and died in 1971.

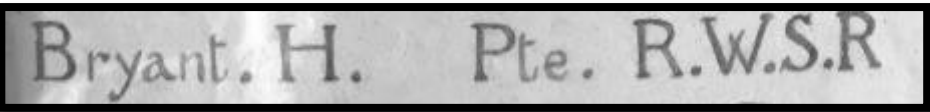

Louis's younger brother, Harry Bryant shown on the St James porch Memorial

The names of Louis's other brothers, Walter James Bryant and Arthur William Bryant are inexplicably not shown on the St James porch memorial to 'Those Who Served'. Walter James also served with the R.W.S.R. He enlisted in November 1915 and survived the war. He lived with his parents in Pontypool. He worked as a gardener and died in 1957.

Arthur William Bryant worked as a grocer's manager and was shown as such on his St James marriage record in 1915. I have not been able to find a WW1 service record for him although we know that if he served, he survived and in 1937 moved from Yew Tree Cottage, Rowledge to open a grocery in Farnham's 12 Downing Street. His son, Sydney, raised in Rowledge to the age of 13 was an RAF Flight Engineer and died in 1944 when his B17 bomber was shot down over Holland. He was just 20 and training to be a pilot. His name is on the Gostrey Meadow Memorial. It should surely be on our Memorial too?

# Appliance Repair

Electric Cooker/Hob  
Tumble dryer  
Dishwasher  
Washing machine  
Fridge/Freezer\*

- Built in and free standing
- New appliances with installation
- Members of **Checkatrade.com**  
Where reputation matters

**Appliance Expert**

\*Built in & American style only

Domestic Appliance repair

**Elstead (01252) 705198**

[www.applianceexpert.co.uk](http://www.applianceexpert.co.uk)

## Window Cleaning

Whitbread's Window Cleaning is based on the edge of Farnham. We offer a regular, reliable window cleaning service at a competitive price. We also clean gutters, fascias, soffits, cladding and conservatory roofs. We currently service over 300 clients on a regular basis every 4, 6 or 8 weeks in the Farnham area alone. Call us now on 01252 449561 or 07533 682062 for a free, no obligation quote.



Traditional Chinese Medicine



**Michael Ng**

LicAc., MBACC

Acupuncturist

4 Swiss Close  
Boundstone  
Farnham  
Surrey

01252 794353



# Rowledge Village Hall News

## **RE-OPENING THE HALL**

The hall has now re-opened with Rowledge Preschool returning after the summer break.

The trustees have agreed to reopen the hall, albeit cautiously and in line with Government guidance, to regular users, fitness classes and clubs.

The safety of the users, especially the children, has to be a priority. Maintaining the necessary level of cleaning to comply with COVID -19 guidelines is a challenge with so many different users accessing the hall in normal circumstances.

Please look at RVH Facebook page and the village notice boards for up to date information on classes as they return.

Over half term, we will be completing essential electrical upgrade works starting on Monday 26th for a week.

## **100 CLUB**

Bob Blackman drew the winning tickets for August.

The lucky winners were Mrs Long (£20) and Mike Haddleton (£50).

100 Club is drawn 6 times a year with proceeds from ticket sales helping to maintain the hall.

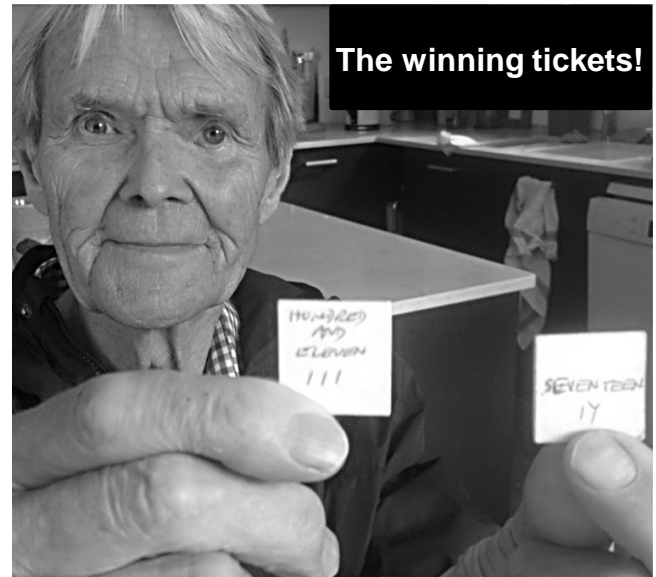

There are a number of tickets available to purchase now as people have moved from the village and their membership has lapsed.

For more information contact [info@rowledgevillagehall.com](mailto:info@rowledgevillagehall.com)



# CALLING ALL KNITTERS

We are looking for knitters to help us knit poppies which will be sown together and used to decorate the village for remembrance. We would like either red poppies or blue poppies so we can also show our continued support, as a village, to our NHS workers.



If you can help knit any poppies, I am happy to collect or you can drop them off to 8 Broad Ha'Penny, on Boundstone Road. There are lots of different patterns online but I can share some easy ones – email [amanda.main@yahoo.co.uk](mailto:amanda.main@yahoo.co.uk) or call 01252 793266.

**Pattern on next page**

# KNITTING PATTERNS FOR POPPIES

*Leaving a length of wool when casting on and off will allow the poppy to be tied. A pin can be attached to make a brooch.*

## KNITTED POPPIES

For the best finish, knit with a Double Knit (DK yarn).

The size of needle you choose will determine how big the poppy will be, but we recommend 3.5mm or 3.75mm (UK9).

If you have different yarn left in your stash, just use that and the appropriate needle size.

If you have any problems with any of the techniques in the poppy patterns - and you have access to the internet - you will find lots of tutorial videos on YouTube.

### 1. Easy garter/knit stitch pattern for beginners

Colour A Red (one ball will make a lot of poppies!)

Colour B Scrap of Black or a black button

#### Body of Poppy

Using Colour A cast on 120 stitches.

Rows: 1-4 Knit

Row 5: Knit 3 stitches together across the row (40 stitches) (or slip 1, knit 2 together, pass slip stitch over the remaining stitch)

Rows 6-9: Knit

Row 10: Knit 2 stitches together across the row (20 stitches)

Rows 11-14: Knit

Row 15: Knit 2 stitches together across the row (10 stitches)

Cut yarn leaving a tail of about 20cm

Thread tail through yarn needle and slip all the remaining live stitches onto the yarn tail and pull tight. Pull around into a circle and then mattress stitch (or use whatever stitching you normally use) to seam for an invisible seam.

Sew in ends, or leave a length so the poppy can be tied.

#### Centre of Poppy

Using B, cast on 16 stitches. Cast off. Coil into a tight spiral and sew base to the centre.

Or use a black or green button with 4 holes and sew to centre of poppy. Add pin.

### 2. Easy ribbed poppy pattern

Colour A 1 ball red yarn (this will make a lot of poppies)

Colour B Scrap of black yarn or black button

#### Body of Poppy

Using Colour A Cast on 60 stitches

Rows 1-10: K2, P2 across whole row (for a slightly smaller poppy do 8 rows of rib).

Row 11: Knit 2 stitches together across the row (30 stitches).

Row 12: Slip 1 stitch, Knit 2 stitches together then pass the slip stitch over... repeat across the whole row (10 stitches).

Break off yarn with long tail and thread back through remaining stitches and pull tight. Join edges with mattress stitch

#### Centre of Poppy

Using B, cast on 16 stitches. Cast off. Coil into a tight spiral and sew base to the centre.

Or use a black or green button with 4 holes and sew to centre of poppy. Add pin.

## Admiral Sir Geoffrey John Audley Miles, K.C.B., K.C.S.I.

Rowledge has been home for many retired military men, not least owing to its proximity to Aldershot. Several of these men became churchwardens, General Lushington being one of the best known. However the most prominent of the several ex-military churchwardens was not an army man, but a son of the Royal Navy. This was Admiral Sir Geoffrey John Audley Miles, K.C.B., K.C.S.I. He was churchwarden during the tenures of the Revd. Arthur Robert Winnett and Canon Frank Page, and continued in this role until the tenure of the Revd. David Eaton.

We have Sir Geoffrey Miles to thank for the name 'The Rowledge Review'. When the Revd. Winnett, in January 1958, enlarged the parish magazine he renamed it *The Rowledge Review* following a suggestion of Sir Geoffrey. The scope of the magazine was extended to include, as well as parish news, news of the Methodist Church and various village activities and organisations. The monthly circulation at the time was 320.



**Geoffrey Miles as a sub-lieutenant in 1910, aged 20.**

Sir Geoffrey was an imposing figure and, at least according to his obituary in the *Rowledge Review*, well liked and respected. Not everyone who watched him progressing about the village realised what a colourful history he had had. Sir Geoffrey must have nursed many extraordinary memories as he played bowls on the green in Rowledge, a game to which he became devoted (he was captain of the bowls team). Perhaps most memorable were those of his time in Moscow. He was in Moscow in 1941-2 with Stalin as part of the British Military Mission. This was one of the truly epochal episodes in world history, as Stalin and the allies jostled with each other over the destinies of millions. Sir Geoffrey sent back to his wife a Kremlin menu - the peasants may have been starving but the Soviet *nomenklatura* looked after themselves rather well.

Or perhaps he remembered exciting times in the dying days of the Raj and his close friendship with Rustom Ghandhi, his flag-lieutenant. Ghandhi went on to become an admiral in the Indian Navy. He had an eventful life himself. He helped save the members of the Bombay Yacht Club though they didn't know it at the time. Ghandhi had been sub-lieutenant in the frigate *Shamsher* during the Indian naval mutiny in 1946 when his captain was urged to shell the Royal Bombay Yacht Club because it refused membership to Indians. The Captain conjured a signal ordering the *Shamsher* to search for a ditched aircraft 80 miles from Bombay, and Ghandhi helped to conduct the fake "search". The club was saved.

Sir Geoffrey's existence in Rowledge was passed rather more peacefully. He lived at



Forest Edge on Boundary Road for twenty years, then at the house called Clunie on the same road. Then he moved to Clare Mead before, finally, moving briefly to Holyport, Maidenhead, near his son's family, where he died. Born in Chelsea on 2 May 1890, he came from a wealthy family. He was the great-grandson of Philip John Miles, Bristol's first millionaire. He trained as a naval officer and made rapid progress in the navy. He was active in both world wars.

You can read of his many exploits in Wikipedia: his commands included HMS Pangbourne (1931–1932), HMS Codrington (1935–1937), Captain (D) 3rd Destroyer Flotilla (Mediterranean) as well as HMS Nelson (1939–1941). He was Head of the British Military Mission in Moscow between 1941 and 1943, Naval Force Commander, Eastern Expeditionary Force, and Deputy Naval Commander, South East Asia Command under Lord Mountbatten, when he was quartered in New Delhi. His career came to an illustrious conclusion when he was made the Flag Officer Commanding the Royal Indian Navy (1946–1947). He was the last commander-in-chief of the Indian Navy before India achieved independence and he relinquished his post on the day of Indian independence. Miles retired in April 1948 with the rank of Admiral. He became president of the naval charity, the Royal Navy Club in 1952.



**A photograph of Sir Geoffrey taken by Walter Stoneman in December 1945.**

In his retirement, Sir Geoffrey was involved in most of what went on in the parish. Had Rowledge been a Papua New Guinean village, he would surely have been its headman.

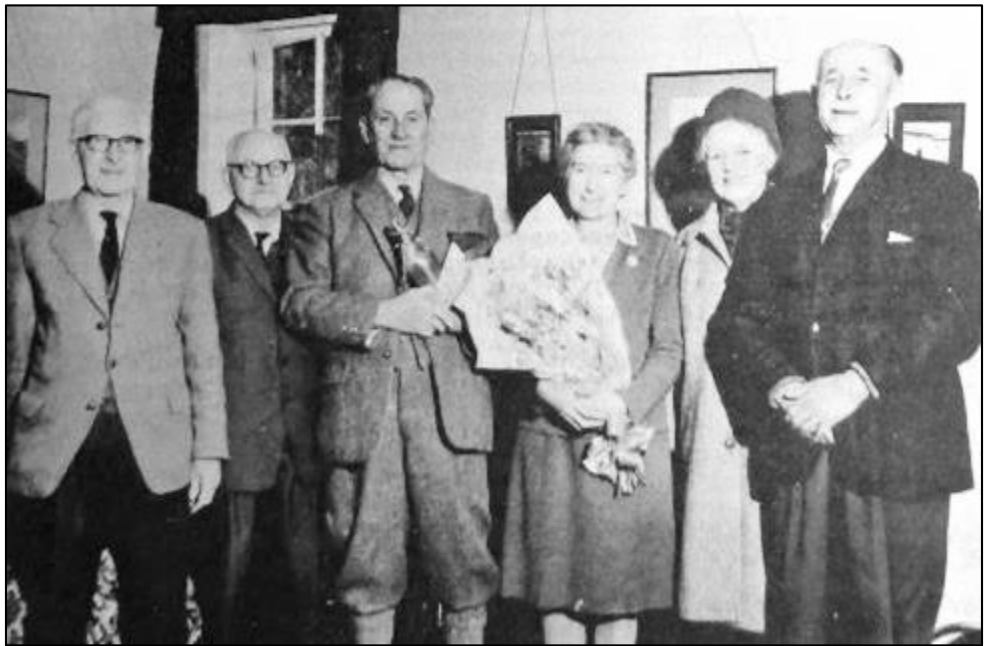

**In 1968, a Golden Wedding Presentation by members of the bowls club, held at Forest Edge on Boundary Road. From left: Canon Frank Page, Mr Arthur Turney, Sir Geoffrey and Lady Miles, Mrs Forman and Mr Fred Kemp. Note Sir Geoffrey's knee breeches.**

He died at the age of 96 on the last day of 1986 and his ashes were interred in the village churchyard where his wife had been buried five years before. The burial service was conducted in St. James' by the Revd. David Eaton.

If you go into the church, near the font you can see a plaque which explains the presence of an historic white ensign presented by Sir Geoffrey Miles. Sir Geoffrey was navigator on H.M.S. Fearless at Jutland and the flag came from this ship. This was not the only gift donated to St. James' by Admiral Sir Geoffrey; in 1953 he gave to the church two white collecting bags.

Sir Geoffrey married his wife, Alison, in 1918 and both their sons went on to military careers. They were Lieutenant-Commander Peter Tremayne Miles of the Royal Navy and Lieutenant Archibald Geoffrey Miles of the Royal Artillery.

Sir Geoffrey Miles' honours were numerous. He was made a K.C.B. (Knight Commander of the Order of the Bath) in 1945 and C.B. (Companion of the Bath) in 1942 and was awarded the Legion of Honour by the French in 1944. He was one of the final recipients of the K.C.S.I. (Knight Commander of the Order of the Star of India) which he received in 1948. In view of his involvement with the Soviets in the Second World War and with India in the last days of the Raj, it may be said with some confidence that of all the 'sons of Rowledge' none had a more significant career in the life of the nation.

## **Farnham Foodbank needs your help!**



Can you help fill a couple of volunteer opportunities?

### **Driver wanted**

We need someone who has a large car or a van who is able to transport food and deliver food boxes. They need to be an experienced driver and physically capable of carrying heavy bags and boxes. It would be working on an ad hoc basis and the Foodbank would cover transport costs at 45p per mile.

### **Packers wanted**

We need people to help pack bags on Monday and Thursday afternoons. This would be on a reserve basis to fill in when existing volunteers already doing this role are away, unwell or having to self-isolate. Volunteers would need to work in pairs (so ideally suited to a couple or two family members as they would not need to social distance) and would need to be able to carry heavy bags and reach for food from shelves which can exceed head height.

If you can help, or have any queries, please contact:  
**Anne Blackman (01252 793344)      THANK YOU!**



# Abbeyfield

## Wey Valley Society



Care homes with a difference  
providing Residential & Nursing care in Farnham

- \* Fees reflect charitable status
- \* Locally sourced home cooked food
- \* All rooms are spacious with en-suite facilities
- \* Wide range of activities
- \* Large input from Volunteers
- \* Weekly summer outings
- \* Pleasant gardens in every home

**All homes provide a real 'home from home'**

Please contact us on 01252 712021 or 899000

Email: [admin@abbeyfieldweyvalley.co.uk](mailto:admin@abbeyfieldweyvalley.co.uk)

[www.abbeyfieldweyvalley.co.uk](http://www.abbeyfieldweyvalley.co.uk)

**STRUTT & PARKER**  
BNP PARIBAS GROUP

Proper partners

# Emma & Will

We don't have clients. Just friends.

If you are thinking  
of selling your home  
contact us today  
[struttandparker.com](http://struttandparker.com)  
01252 751623

## Members' Community Allocation funding

Each county councillor has £5,000 funding for 2020/21 to help residents, voluntary and community organisations deliver activities that benefit local people in their neighbourhoods. This funding is known as Members' Community Allocation.

Members' Community Allocation funding can be used for one-off activities that cost just a few pounds, alternatively it can contribute to projects that cost much more. The funding is flexibly designed to help with costs that can range from purchasing sports equipment for local clubs, to the creation of websites to reach more residents.

The online applications for funding will be open from 1 September 2020 until 29 January 2021.

If you are interested in applying for Members' Community Allocation funding, here's how to do it:

- Make sure that your project fits within our funding criteria
- **Contact your local county councillor to discuss your project** and see if it is something that they would consider supporting. Remember that councillors often get requests that exceed the amount they have to spend but they may be able to advise about other funding sources that could help you.
- If your county councillor is happy to support your project, they will send you instructions on how to complete an online application.
- Once you have completed the form and all the mandatory information is included, it is automatically sent to the Community Partnership Team for processing and ultimate approval.
- If you need support during your application, our team can help. You can email them at [communitypartnerships@surreycc.gov.uk](mailto:communitypartnerships@surreycc.gov.uk) or have a look at our video of hints and tips on filling out your application form.
- If your application is successfully submitted, you will receive an email confirming receipt. You will be given a unique reference number during the application process which you should note down and quote whenever you contact us about your application.
- The Community Partnership Team may contact you to request further supporting information or to ask for clarification about some of the details contained in your application.
- If your application is approved, you will receive a confirmation email. If your application is rejected, you will similarly receive an email advising you of the outcome.
- Once funding is approved, it is likely to take up to two weeks before the money is paid into your organisation's bank account.
- We require all successful organisations to provide us with evidence that the project has been completed. This helps us to account for how we have used our



funding. It also forms the basis of our website and social media activities that promote the community benefit of your project.

Dear All,

If you are thinking of seeking a grant from my allocation this year, please note that the deadline for completed applications is the 29<sup>th</sup> of January. The information above sets out the formal part of the process.

However, the first thing to do, is to agree with me what the application is for and how much the grant should be for. Note that I like to use my grant to help fund new activities or help expand activities, I am not comfortable simply contributing to ongoing revenue expenditure. To do this efficiently I would like any initial approaches to be with me by early December. Leave it too late and the limited amount might already be promised elsewhere.

Please do share/forward this message to other worthwhile causes that specifically serve the people of Farnham South.

Best wishes,

Wyatt

**Cllr Wyatt Ramsdale** (Surrey County Councillor for Farnham South)

Mob: 07771 674634

**YOU can make a difference to a family in your community.**

Many parents need help, friendship, advice or support during those early years when children are young. Your experience as a parent can help others. There are a variety of ways you can volunteer for Home-Start WeyWater.



Home-Start WeyWater  
Alton, Bordon & Liphook

**Home Visiting Volunteer** - Home-Start provides a unique service for families - recruiting and training volunteers to support parents with young children at home.

**Trustee** - with your skills and experience you will have an input on how our scheme runs and develops in the future.

**'Friend'** - you can help us raise our profile in your community and help with our ongoing fundraising.

**Home-Start WeyWater, c/o Chase Children's Centre, Budds Lane, GU35 0JB**  
**Tel - 01420 473555 E-mail - [office@homestart-weywater.org.uk](mailto:office@homestart-weywater.org.uk)**

## Volunteers Needed in Phyllis Tuckwell Shops

**Local charity Phyllis Tuckwell Hospice Care is in need of more volunteers to help in its 18 charity shops, which are located across West Surrey and North-East Hampshire.**

If you're a people person, you'll love the social interaction that volunteering in Phyllis Tuckwell's busy shops will bring, as you help new and regular customers, and get to know the other staff and volunteers there.

Back in March, lockdown closed all of Phyllis Tuckwell's shops, and although most have now re-opened, many of its volunteers have been unable to return to help in them, and consequently some of the shops are now operating on reduced opening hours. The shops bring in vital funds for the charity, which

cares local for patients and families who are living with an advanced or terminal illness, such as cancer, but they cannot operate without the help of its volunteers.

"We urgently need more volunteers to help us get our shops fully open," said Peter Foxton, Director of Income Generation at Phyllis Tuckwell. "We offer flexible shifts and a varied working day, with volunteers helping to serve customers, operate the till, and sort, steam and price stock. We have introduced Covid-secure processes to keep our staff and volunteers safe, including quarantining stock and enhanced levels of cleanliness."

You'll be given training and learn new skills, and, with morning or afternoon shifts available, you'll be able to fit it in around your other commitments. Best of all, you'll know that by giving your time, you'll be helping to raise money to support local patients and their families, at probably the most difficult time in their lives.

Throughout the Coronavirus pandemic, Phyllis Tuckwell has continued to provide supportive and end of life care for local patients and families who are living with an advanced or terminal illness, providing 24-hour front line care at the Hospice in Farnham and in patients' own homes. However, it has to raise over £20,000 a day to provide this care, and with many of its fundraising events cancelled, its retail shops are now more important than ever in helping it raise the money it needs.

To find out more about becoming a retail volunteer, please contact Phyllis Tuckwell's Voluntary Services team on **01252 729400** or email **[voluntary.services@pth.org.uk](mailto:voluntary.services@pth.org.uk)**. Just a few hours of your time can make a big difference.



# “Lots going on”

Real words from happy residents, during lockdown.



Our villages are filled with people who, more than ever, truly appreciate *the power of community* in later life.

Is now the right time to move to an Inspired village?

**BRAMSHOTT  
— PLACE —**

*Inspired* in Hampshire

**MOVE FREE,  
MOVE NOW!\***

✓ No stamp duty on any of our properties.

✓ We cover the costs of selling your property, removals, your legal fees and decluttering.

Come and look around safely, please call us on **01428 787 458** or visit [bramshottplace.co.uk/TimeToMove](http://bramshottplace.co.uk/TimeToMove)

\*Terms & conditions apply. Please see our website for full details.

A photograph of four blue trucks parked in a row. The trucks are used for tree surgery and stump grinding. The text 'Tree Surgery', 'Hedges', and 'Stump Grinding' is overlaid on the image.

**Tree Surgery   Hedges   Stump Grinding**

A green silhouette of a tree with the text '1st Call' in a large, stylized font.

**1st Call**  
PROFESSIONAL BY NATURE

- Local Authority Approved
- Fully Insured
- NPTC Qualified Staff
- Free Quotations
- Domestic & Commercial Contracts

**Farnham 01252 782252   Guildford 01483 425266   Alton 01420 525292**  
**24 Hour Emergency Call Out   [www.1stcalltrees.com](http://www.1stcalltrees.com)   [info@1stcalltrees.com](mailto:info@1stcalltrees.com)**



## A return to worship

### Sunday 30<sup>th</sup> August

St James' Church, held its first Communion service since the lockdown on Sunday 30<sup>th</sup> August – albeit, outside in the Churchyard.

It was great to be able to come together as the Family of God in Rowledge - and the weather did not disappoint – the sun shone. A real blessing!



The congregation were invited to bring their own garden chairs and face mask if they wished, and also their own bread and red wine (or non-alcoholic alternative) for Communion. These were consecrated during the service and then consumed in household groups, without the need for the Vicar or others to handle them.

It was a special time to share communion together.



### Sunday 20<sup>th</sup> September

A return to worship in the church building.

Rev Russ Gant held our first service in the church building since lockdown on Sunday 20<sup>th</sup> September, which included Holy Communion.

The congregation have been asked to feedback views about the format to help the PCC plan future services.





🐾 *Pride and Groom* 🐾

*GROOMING FOR ALL  
BREEDS OF DOG*



- *Bathing*
- *Grooming*
- *Clipping*
- *Trimming*

For a friendly and professional  
service please ring:

**Jenny**

07790 595576

## **A. STRUDWICK**

YOUR LOCAL

Painter & Decorator

Interior & Exterior

Paper Hanging Specialists

General Building Repairs

Burglary Prevention

**PHONE : 01252 792077**

## **Andrew Pearson Plumbing & Heating Engineers**

- Full bathroom suite installations
- Central heating systems
- Power shower systems
- All work guaranteed

Free quotations



**0777 038 6827**

**0777 598 7773**



**Church Website –Take a look! Updated regularly**

**[www.stjamesrowledge.org.uk](http://www.stjamesrowledge.org.uk)**

**Take a look at our website.**

Full of interesting information and details of everything going on at St James'.

***We'd love to hear your comments.***



## **BED AND BREAKFAST**

### **IN AID OF CHIKS CHARITY**



(for orphaned children in Southern India, run by a village resident)

**On the edge of Rowledge Village, a double en-suite ground floor room is available with plenty of off road parking.**

**Full English breakfast and a warm welcome.**

**01420 22292 [annfoster222@gmail.com](mailto:annfoster222@gmail.com)**



**WEST END FLOWER FARM**  
— Farming in Froyle since 1920 —

The flower farm is open for walks around the farm, see the rose field and wander the lake; well behaved dogs are welcomed too. In addition the farm has a B&B and self-catered cottage so please do bear us in mind for visiting families and friends.

**West End Flower Farm Shop and Kitchen in Upper Froyle, just outside Alton is now open to the public from Wednesday – Sunday.**

The kitchen serves brunch, lunch and afternoon tea using local produce and delicious cakes. The farm shop has fresh flowers, gardening items and local artisan products too.

Please do come and visit us **[www.westendflowerfarm.co.uk](http://www.westendflowerfarm.co.uk)**

## **2 mornings a year volunteer! - Village Tidy-Up**

Having coordinated the Village Tidy-Up twice a year, for many years on behalf of the Residents Association, Phil Thomas would like to hand over the reins to someone else.

If you want to help keep the village looking spic and span, please speak with Phil or Jeff Ward who will explain what is involved in this important and highly valued role.



**[philthomas36@btinternet.com](mailto:philthomas36@btinternet.com)**

**[wardjeff99@btinternet.com](mailto:wardjeff99@btinternet.com)**

## Luminosa's Youth Choirs Continue to Shine

Throughout lockdown, Luminosa Young and Rising Voices have continued to rehearse enthusiastically each week on Zoom. However, these young singers and their teachers are now excited to announce that they will be back singing face-to-face at The Maltings, Alton each Tuesday from September at 5.45pm.

In a bid to acknowledge and thank frontline NHS staff and keyworkers, their repertoire will be well-known songs from movies and musicals, incorporating famous composers, classical and contemporary, to broaden the young singers' vocal experiences, all celebrating heroism in its many guises.

Rising Voices (ages 10-16) work on singing technique and stage presence, while Young Voices (ages 7-10) enjoy musical games, building on basic singing skills and confidence. All young singers learn to sing in a nurturing, caring environment where they can grow in individual confidence, form friendships, be part of something collaborative and develop resilience, as well as learn a skill that will enhance their love of music for a lifetime.



**Sweet smiles of success after coming second in the Youth Choirs Competition, March 2020**



The Maltings is a stringently risk-assessed rehearsal environment, fully compliant with Covid-19 regulations, including full sanitisation and social distancing. The Choirs' volunteers and professional musicians, themselves teachers, are up to date with the latest government advice and guidance and all are DBS checked.

Further information can be found on Luminosa's website [www.luminosamusic.com](http://www.luminosamusic.com), on Facebook [www.facebook.com/LuminosaYoungandRisingVoices](https://www.facebook.com/LuminosaYoungandRisingVoices) and Instagram [@luminosa\\_rising-voices](https://www.instagram.com/luminosa_rising-voices)

# Fun time

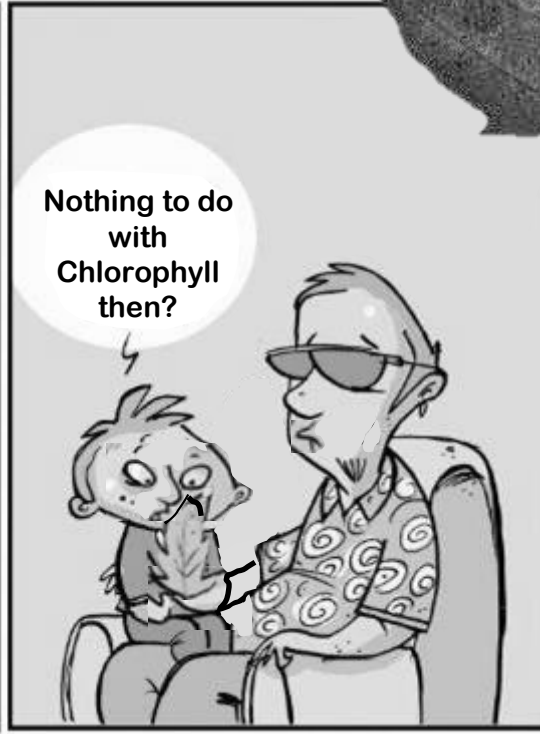
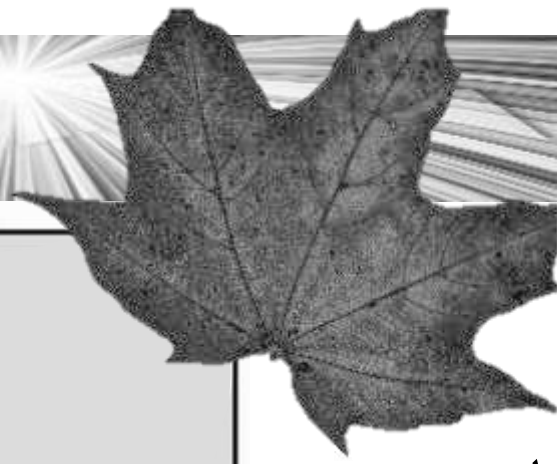

What kind of vest should you wear in the Autumn?  
A Harvest!

What month does every tree dread?  
Sep – timmmberrr!



	2			8				7
	1			6			5	
3			9					
			3				1	4
		7				6		
6	4				7			
					2			5
	3			9			2	
5				3			4	

Think of raking leaves as Mother Nature's way of getting you in shape for shovelling snow!

**Sudoku** Each puzzle has a solution that can be reached logically without guessing. Enter digits from 1 to 9 into the blank spaces. Every row must contain one of each digit. So must every column, as must every 9 space shape.



## Farnham Food Bank

**At this difficult time, please do support your local Foodbank.**

Donations can be made at St. James' Church, Rowledge Co-Op, Waitrose or at Anne Blackman, 12 Prospect Road or Mike Randall at Poplars, 7 The Avenue.

There is a huge increase in need at the moment, especially from those families who would usually be reliant on school dinners.

To access the foodbank should you be in need, please see contact details below.

**WEBSITE - <https://farnham.foodbank.org.uk>**

**EMAIL - [info@farnham.foodbank.org.uk](mailto:info@farnham.foodbank.org.uk)**

You can also contact St. James' Church Office to collect Foodbank vouchers.

The Church Office,  
Church Lane,  
Rowledge,  
GU10 4EN.

PHONE - 01252 792402

EMAIL - [admin@stjamesrowledge.org.uk](mailto:admin@stjamesrowledge.org.uk)

The Foodbank would also be very grateful for any financial contributions you feel moved to make.

If you have any queries, do contact:

**Anne Blackman (01252 793344)**

**THANK YOU!**

***"The foodbank was there when we really needed it, it was an absolute lifeline."***

Foodbank urgently need:

**Tinned Potatoes,  
Dried milk powder,  
Vegetable oil  
Raisins**

At the moment they have plenty of:  
Cereals, Biscuits, Pasta, Tinned vegetables, Baked beans, butter beans, chick peas, kidney beans, lentils, long life fruit juice and UHT milk

## NEW Foodbank Vouchers

St James' Church is now able to issue foodbank vouchers for those in need. To be eligible for an emergency food parcel as an individual or a family, you will need to be referred with a voucher from the church office.

Your referral will be completely confidential. If you or someone you know is in need then please contact the church office on 01252 792 402.





## EDITORIAL

**PLEASE NOTE:** The official deadline for copy for the November issue of the Review is **FRIDAY 9<sup>th</sup> October 2020.... LATEST DATE!!**

Please either send articles through email: **rowledgereview@yahoo.co.uk**

or leave your masterpieces in the pigeonhole provided in St James' Church.

We always welcome your contributions and would love to hear from anyone who think they could contribute a series of articles on a theme – any subject considered.

**Please also continue to notify us of any required changes to the Directory listing.**

## ADVERTISING

### Rowledge Review Advertising

Maggie Blyth handles our advertising sales.

**If you want to promote your business through these pages, you can contact Maggie on:**

**01252 790660      maggie.v.blyth@gmail.com**

Please send articles to **rowledgereview@yahoo.co.uk** not to anyone else's personal email accounts.

Thanks



# PJ Welch

## Electrical, Plumbing, Gas

Mobile: 078 765 64 63 0

01252 721251

**Pwelch700@gmail.com**



**PART P**

REPLACEMENT BOILERS

CYLINDERS

BOILER REPAIRS, SERVICING, LANDLORD CHECKS

BATHROOMS, KITCHENS, TAPS & SHOWERS

LED LIGHTING, FUSEBOARDS, FAULTS

EXTRA POINTS, CAT6, TV MOUNTING

## **BARRINGTONS** **SOLICITORS**

Residential Conveyancing  
Wills & Probate  
Powers of Attorney  
Corporate / Commercial  
Commercial Property  
Employment & Settlement Agreements  
Debt Recovery  
Equity Release / Lifetime Mortgages

6 St George's Yard  
Castle Street  
Farnham  
GU9 7LW  
Tel: 01252 741751

[www.barringtons-solicitors.co.uk](http://www.barringtons-solicitors.co.uk)  
[info@barringtons-solicitors.co.uk](mailto:info@barringtons-solicitors.co.uk)

## **THORNE LEGGETT**

Independent family funeral directors

Geoffrey M. Thorne M.B.I.E Dip F.D L.M.B.I.F.D

Gill Thorne Dip F.D L.M.B.I.F.D

Michael Thorne Dip F.D. L.M.B.I.F.D

Robin Thorne Dip F.D. L.M.B.I.F.D.

Simon Goff Dip F.D

*Here to support you in your time of need.*

Immediate 24 hour assistance

8-10 The Street, Wrecclesham, Farnham, Surrey, GU10 4RP  
Farnham 01252 715520

[www.thorne-leggett.com](http://www.thorne-leggett.com)



# Nash Electrical Services

39 Boundstone Road, Farnham, Surrey GU10 4TW

Domestic and Commercial Contractors  
Rewires, Extensions, Alterations  
Inspection, Testing and Certification  
Fault Finding and Repair  
No Job Too Small



Fully 'Part P' Compliant  
Established 1980



**Phone: 01252 794178 [www.nashelectrical.co.uk](http://www.nashelectrical.co.uk)**

## ROWLEDGE GARAGE MOTOR ENGINEERS

Rowledge Garage supply and fit all makes of tyres.  
We also carry out full wheel alignment and adjustments.

**Phone : (01252) 792379**

**Mobile : 07442 490521**

**Martin Hoare**

**ROWLEDGE, FARNHAM, SURREY GU10 4AA**  
**E MAIL: ROWLEDGEGARAGE@BTCONNECT.COM**

